

Project Boundary Line Traverse

From - To	Bearing	Distance
0-1	N 71°00' W	39'
1-2	N 07°00' E	300'
3-4	S 62°30' W	198'
4-5	N 30°00' E	156'
6-7	S 25°30' W	704'
7-8	N 51°00' W	225'
8-9	S 42°30' W	400'
9-10	S 32°30' E	300'
10-11	N 72°00' W	380'
11-12	S 43°00' W	400'
12-13	S 70°00' W	595'
13-14	S 01°00' W	600'
14-15	N 48°00' W	475'
15-16	S 27°00' W	450'
16-17	S 50°30' W	271'
17-18	S 37°00' W	1127'
18-19	N 57°30' W	283'
19-20	S 43°30' W	510'
20-21	S 13°00' W	795'
21-22	S 19°56' E	400'
22-23	S 50°30' W	725'
23-24	S 27°00' W	950'
24-25	S 73°00' W	600'
25-26	N 67°45' W	575'
26-27	N 33°30' W	425'
27-28	S 72°01' W	240'
28-29	S 23°20' W	575'
29-30	S 24°00' W	460'
30-31	S 24°30' E	370'
31-32	S 66°30' W	240'
32-33	N 25°45' W	325'
33-34	S 77°15' W	245'
34-35	S 51°15' W	548'
35-36	N 50°00' W	190'
36-37	N 46°00' E	350'
37-38	N 69°00' W	1550'
38-39	N 09°00' E	378'
40-41	N 31°15' W	273'
41-42	N 66°00' E	572'
42-43	S 29°30' E	220'
43-44	N 85°50' E	250'
44-45	S 67°07' E	382'
45-46	N 40°00' E	200'
46-47	S 60°00' E	1300'
47-48	N 35°30' E	408'
48-49	N 19°00' E	560'
49-50	N 65°00' W	490'
50-51	N 88°00' W	600'
51-52	S 40°00' W	468'
52-53	N 00°45' W	650'
53-54	S 89°15' W	170'
54-55	N 24°15' E	240'
55-56	S 82°15' W	164'
56-57	N 19°45' W	563'
57-58	N 18°15' E	188'
58-59	S 59°40' E	115'
59-60	S 05°20' W	470'
60-61	S 32°40' E	680'
61-62	N 59°10' E	365'
62-63	S 62°50' E	193'
63-64	S 01°00' W	140'
64-65	S 88°30' E	585'
65-66	S 38°00' E	590'
66-67	N 81°30' E	287'
67-68	S 72°39' E	579'
68-69	N 74°00' E	470'
69-70	N 53°30' E	708'
70-71	N 00°00' E	350'
71-72	N 18°00' E	325'
72-73	N 44°15' W	508'
73-74	N 12°00' W	579'
74-75	N 24°00' W	1007'
75-76	S 50°00' E	980'
76-77	N 64°00' E	590'
77-78	N 01°30' W	335'
78-79	S 71°30' E	205'
79-80	N 18°00' E	315'
80-81	S 76°00' E	580'
81-82	N 15°00' E	60'
82-83	S 76°00' E	510'
83-84	N 75°30' E	900'
84-85	N 22°39' W	249'
85-86	N 83°29' W	882'
86-87	N 00°44' W	310'
87-88	N 62°48' E	621'
88-89	N 80°00' E	1075'
89-90	N 44°00' E	380'
90-91	N 44°00' E	380'

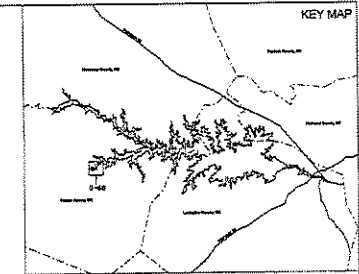
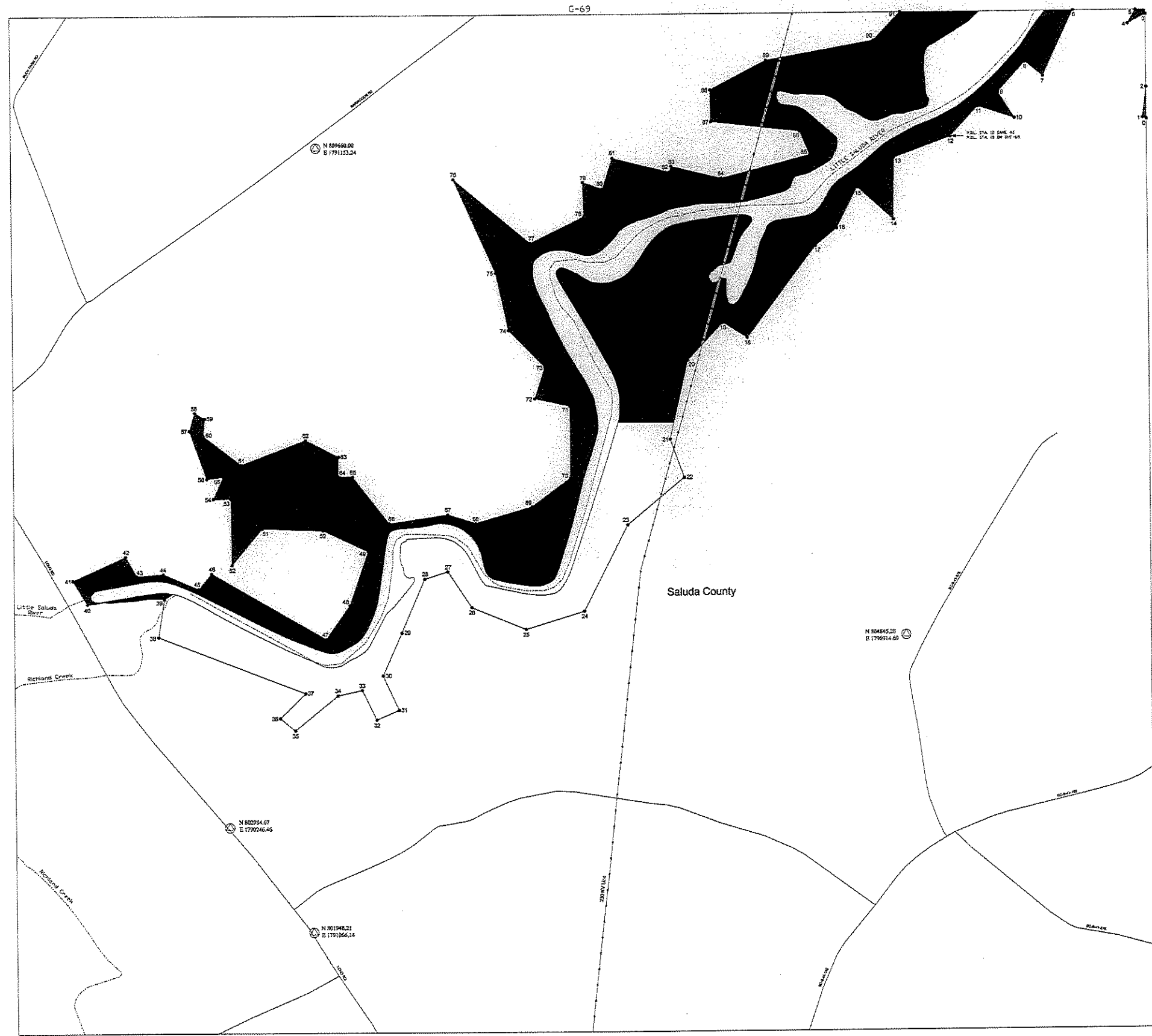

LEGEND

- Railroad
- Pipeline
- Transmission line
- Road
- Project Boundary Line
- Maximum Normal Operating Level (MNOL)
- Stream
- County Boundary
- Property owned in Fee by S.C.E. & G.
- ▨ Recreation areas owned in Fee by S.C.E. & G.

HORIZONTAL DATUM BASED ON THE SOUTH CAROLINA STATE PLANE COORDINATE SYSTEM NAD83/2011 (INTERNATIONAL FOOT).

VERTICAL DATUM BASED ON NAVD83 (FEET).

TO CONVERT FROM S.C.E. & G. PLANT DATUM (PD) TO NAVD83 ADD +61.5'. THE PROJECT BOUNDARY HEREIN IS DEFINED BASED ON S.C.E. & G. SURVEYS AND RECORDS SURVEYS AND RECORDS OF RECORDS UNLESS OTHERWISE NOTED. ALL AREAS OF THE PROJECT BOUNDARY THAT ARE ELEVATION CONTROLLED WERE PROVIDED BY S.C.E. & G. AND MARKED BY US&S, INC.

STEREOPLOTTER PROCESS IN ACCORDANCE WITH NATIONAL MAP ACCURACY STANDARDS. AERIAL PHOTOGRAPHY WAS FLOWN AT A SCALE APPROXIMATELY 1 INCH = 500 FEET.

I, GERRARD SHUMAKER, A PROFESSIONAL SOUTH CAROLINA PHOTOGRAMMETRIC SURVEYOR/PAPERER HAVE REVIEWED THE LARGE SURVEY PLANT MAP. THE PHOTOGRAMMETRIC AND COMPUTED SHOWS OF SAID MAPS ARE IN ACCORDANCE WITH THE NATIONAL MAP ACCURACY STANDARDS FOR THE SCALE OF 1"=500' AND WERE PRODUCED USING PHOTOGRAMMETRIC METHODS UNDER MY DIRECT SUPERVISION. ALL WORK IS BASED ON NAD83/2011 (INTERNATIONAL FOOT) AND THE VERTICAL DATUM IS NAVD83 (FEET).

THIS DOCUMENT WAS ORIGINALLY ISSUED AND SEALED BY GERRARD SHUMAKER, 1-24533, ON JULY 2, 2008. THIS MAP SHALL NOT BE CONSIDERED A CLASSIFIED DOCUMENT.

I, GARY EATON, A PROFESSIONAL LAND SURVEYOR IN THE STATE OF SOUTH CAROLINA P.L.S. 12165, HAVE REVIEWED THIS PORTION OF THE LARGE SURVEY PROJECT BOUNDARY SHOWN HEREIN. THE LICENSEE EITHER OWNS IN FEE SIMPLE OR POSSESSES LICENSED GASBORNE OILS THE LAND SHOWN ON THIS MAP THAT ARE INSIDE THE PROJECT BOUNDARY. THE PROJECT BOUNDARY LINES THAT ARE NOT CONVEYED LINES WERE BASED ON S.C.E. & G. SURVEYS AND RECORDS SURVEYS AND RECORDS OF RECORDS.



EXHIBIT G SHEET G-68

DETAIL MAP OF PROJECT AREA
SHEET 68 OF 77
SALUDA HYDROELECTRIC PROJECT NO. 516
SOUTH CAROLINA ELECTRIC & GAS COMPANY

SCALE: 1 INCH = 400 FEET

0 400 800 1,600
FEET

DATE: AUGUST 2008