

Project Boundary Line Traverse

| From - To | Bearing    | Distance |
|-----------|------------|----------|
| 0-1       | N 46°00' W | 497'     |
| 1-2       | N 71°00' E | 720'     |
| 2-3       | N 61°30' W | 740'     |
| 3-4       | N 88°45' W | 99'      |
| 5-6       | N 71°30' E | 862'     |
| 6-7       | S 40°01' E | 620'     |
| 7-8       | N 16°00' W | 737'     |
| 8-9       | N 55°45' E | 464'     |
| 9-10      | N 05°00' W | 339'     |
| 10-11     | S 40°00' E | 490'     |
| 11-12     | N 22°00' E | 845'     |
| 12-13     | N 41°30' E | 120'     |
| 13-14     | N 55°30' W | 480'     |
| 14-15     | N 89°30' E | 514'     |
| 15-16     | N 33°15' E | 174'     |
| 16-17     | S 65°00' E | 540'     |
| 17-18     | S 07°00' W | 470'     |
| 18-19     | N 77°00' E | 200'     |
| 19-20     | N 63°00' E | 500'     |
| 20-21     | S 34°00' E | 1740'    |
| 21-22     | N 83°35' E | 278'     |
| 22-23     | N 17°30' W | 1080'    |
| 23-24     | N 19°30' W | 420'     |
| 24-25     | N 03°00' E | 445'     |
| 25-26     | S 78°30' E | 980'     |
| 26-27     | N 78°30' E | 373'     |
| 27-28     | N 40°15' W | 808'     |
| 28-29     | N 42°20' W | 681'     |
| 29-30     | N 15°30' W | 750'     |
| 30-31     | S 84°45' E | 770'     |
| 31-32     | S 23°45' W | 700'     |
| 32-33     | N 89°20' E | 551'     |
| 33-34     | N 87°00' E | 463'     |
| 34-35     | N 78°30' E | 1425'    |
| 35-36     | N 51°05' W | 630'     |
| 36-37     | N 62°30' E | 800'     |
| 37-38     | N 23°00' E | 270'     |
| 38-39     | S 87°00' E | 715'     |
| 39-40     | S 87°00' E | 195'     |
| 40-41     | N 11°30' W | 812'     |
| 41-42     | S 81°15' E | 958'     |
| 42-43     | S 89°14' E | 486'     |
| 43-44     | S 21°30' E | 698'     |
| 44-45     | N 59°00' E | 405'     |
| 45-46     | S 23°00' E | 305'     |
| 46-47     | S 59°30' W | 600'     |
| 47-48     | S 30°00' W | 427'     |
| 48-49     | S 30°58' E | 426'     |
| 49-50     | S 33°00' E | 150'     |
| 50-51     | N 88°30' E | 963'     |
| 51-52     | S 44°00' W | 440'     |
| 52-53     | N 76°15' W | 707'     |
| 53-54     | S 74°00' W | 190'     |
| 54-55     | S 23°00' E | 440'     |
| 55-56     | S 00°00' E | 267'     |
| 56-57     | S 63°00' W | 541'     |
| 57-58     | S 71°00' E | 490'     |
| 58-59     | S 42°00' W | 660'     |
| 59-60     | N 84°45' E | 300'     |
| 60-61     | N 70°00' E | 526'     |
| 61-62     | N 05°30' W | 240'     |
| 62-63     | N 87°00' E | 310'     |
| 63-64     | N 15°00' W | 390'     |
| 64-65     | S 67°00' E | 450'     |
| 65-66     | N 47°30' E | 407'     |
| 67-68     | S 15°30' W | 138'     |
| 68-69     | N 71°00' E | 39'      |
| 70-71     | S 38°36' W | 659'     |
| 71-72     | N 73°00' E | 430'     |
| 73-74     | N 88°30' W | 325'     |
| 74-75     | S 45°15' W | 805'     |

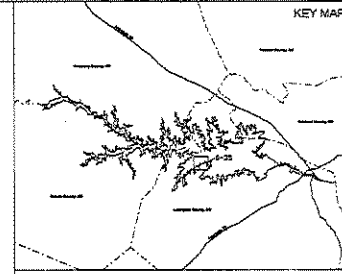
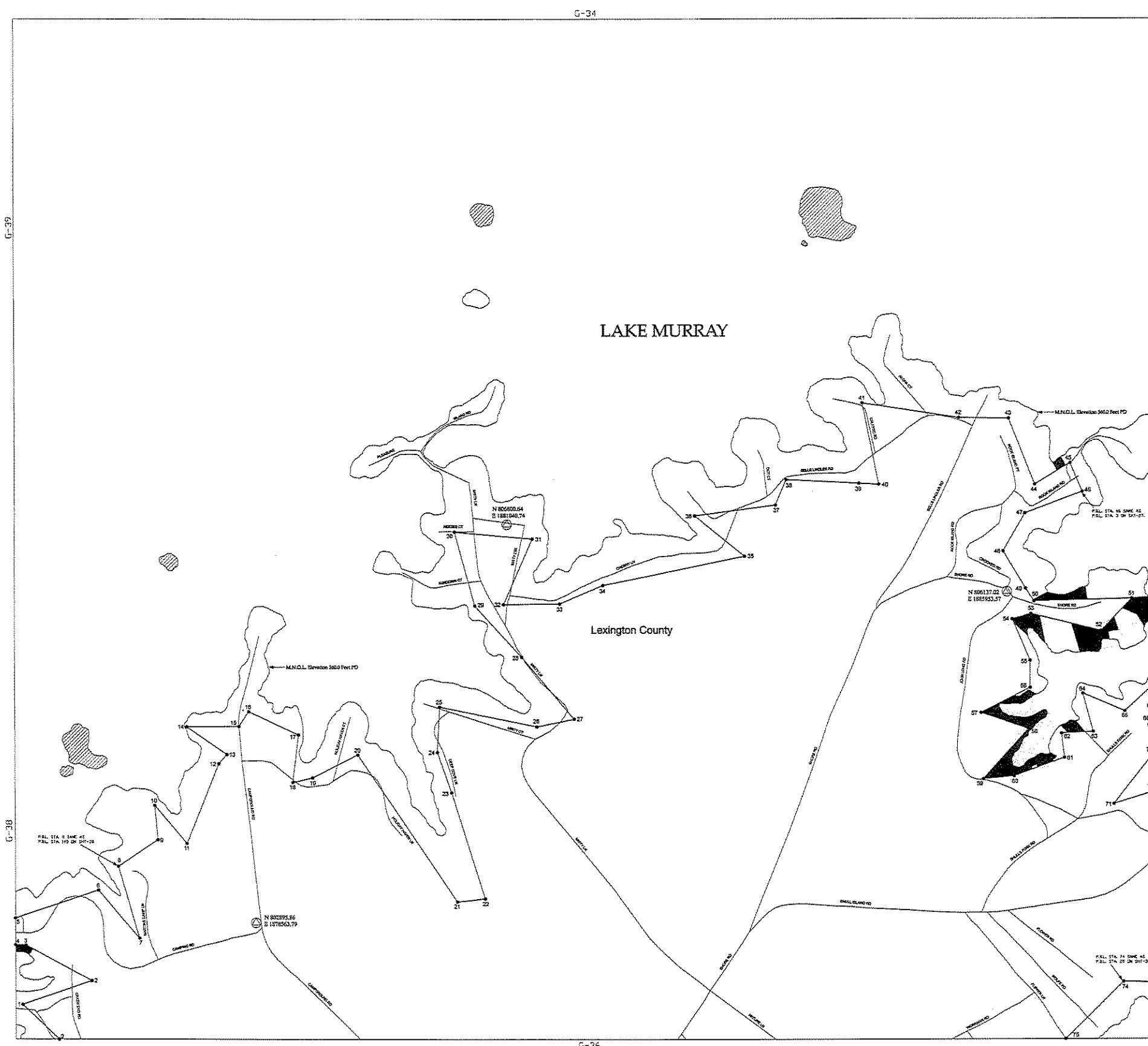

**LEGEND**

- Railroad
- Pipeline
- Transmission line
- Road
- Project Boundary Line
- Maximum Normal Operating Level (M.N.O.L.)
- Stream
- County Boundary
- Property owned in Fee by S.C.E. & G.
- ▨ Recreation areas owned in Fee by S.C.E. & G.

HORIZONTAL DATUM BASED ON THE SOUTH CAROLINA STATE PLANE COORDINATE SYSTEM 1983/2001 (INTERNATIONAL FOOT).

VERTICAL DATUM BASED ON NAVD83 (FEET).

TO CONVERT FROM S.C.E. & G. PLANT DATUM (PD) TO NAVD83 USE THE FOLLOWING EQUATION: NAVD83 = PD + 43.17'. THE PROJECT BOUNDARY BEING IS DERIVED BASED ON S.C.E. & G. SURVEYS AND RECORDED SURVEYS AND DEEDS OF RECORD UNLESS OTHERWISE NOTED. ALL AREAS OF THE PROJECT BOUNDARY THAT ARE ELEVATION CONTROLLED WERE PROVIDED BY S.C.E. & G. AND MAPPED BY OMBIA, INC.

STEREOREDUCTION PROCESS IN ACCORDANCE WITH NATIONAL MAP ACTUITY STANDARDS. AERIAL PHOTOGRAPHY WAS FLOWN AT A SCALE APPROXIMATELY 1 INCH = 600 FEET.

J. GERRARD STRICKLER, A PROFESSIONAL SOUTH CAROLINA PHOTOGRAMMETRIC SURVEYOR/MAPPER HAS REVIEWED THE LAKE MURRAY PROJECT MAPS. THE PLANIMETRIC AND CONTOUR SHOWN ON SAID MAPS ARE IN ACCORDANCE WITH THE NATIONAL MAP ACTUITY STANDARDS FOR THE SCALE OF 1"=400' AND WERE PRODUCED USING PHOTOGRAMMETRIC METHODS UNDER MY DIRECT SUPERVISION. ALL WORK IS BASED ON NAVD83/2001 SOUTH CAROLINA STATE PLANE COORDINATE SYSTEM (INTERNATIONAL FOOT) AND THE VERTICAL DATUM IS NAVD83 (FEET).

THIS DOCUMENT WAS ORIGINALLY ISSUED AND SEALED BY GERRARD STRICKLER, L-24523, ON JULY 1, 2004. THIS MAPS SHALL NOT BE CONSIDERED A CERTIFIED DOCUMENT.

J. DAVID GARDIN, A PROFESSIONAL LAND SURVEYOR IN THE STATE OF SOUTH CAROLINA P.L.C. 13163, HAS REVIEWED THIS PORTION OF THE LAKE MURRAY PROJECT BOUNDARY SHOWN HEREIN. THE LOCATIONS REFERRED TO IN THE TITLE OF THIS DOCUMENT, FILED MAPS OVER THE LANDS SHOWN ON THIS MAP THAT ARE WITHIN THE PROJECT BOUNDARY. THE PROJECT BOUNDARY SHOWS THAT ARE NOT CONTROL LINES WERE DERIVED ON S.C.E. & G. SURVEYS AND RECORDED SURVEYS AND DEEDS OF RECORD.



EXHIBIT G SHEET G-35

DETAIL MAP OF PROJECT AREA  
SHEET 35 OF 77  
SALUDA HYDROELECTRIC PROJECT NO. 516  
SOUTH CAROLINA ELECTRIC & GAS COMPANY

SCALE: 1 INCH = 400 FEET

0 400 800 1,600  
FEET

DATE: AUGUST 2006