

Project Boundary Line Traverse		
From - To	Bearing	Distance
0-1	N 48°00' E	17'
1-2	N 42°30' W	725'
2-3	S 75°00' W	180'
3-4	N 46°30' W	230'
4-5	N 46°30' W	190'
5-6	N 73°45' E	625'
6-7	S 26°00' E	263'
7-8	S 23°15' E	135'
8-9	N 86°30' E	510'
9-10	S 72°00' E	420'
10-11	N 38°00' E	485'
11-12	N 86°00' E	280'
12-13	S 69°30' E	279'
13-14	N 22°00' E	270'
14-15	N 85°00' E	97'
15-16	N 00°35' W	450'
16-17	S 72°30' W	400'
17-18	S 72°30' W	225'
18-19	N 45°30' W	200'
19-20	N 38°15' E	250'
20-21	N 38°15' E	100'
21-22	N 63°00' W	207'
22-23	N 62°59' W	250'
23-24	N 25°03' E	125'
24-25	N 68°00' E	192'
25-26	S 82°00' E	614'
26-27	N 16°45' E	290'
27-28	N 45°00' W	490'
28-29	N 89°00' E	470'
29-30	N 02°00' E	290'
30-31	N 36°00' E	350'
31-32	N 78°00' W	600'
32-33	N 76°00' W	450'
33-34	S 43°00' W	850'
34-35	S 44°00' W	321'
35-36	N 81°00' W	424'
36-37	N 22°00' E	466'
37-38	S 79°00' W	297'
38-39	N 38°00' W	480'
39-40	S 52°00' W	400'
40-41	N 41°00' E	250'
41-42	N 45°00' E	620'
42-43	S 75°00' E	704'
43-44	N 23°00' W	1207'
44-45	N 59°00' E	150'
45-46	N 06°00' W	670'
46-47	N 30°00' E	380'
47-48	S 23°00' E	1840'
48-49	N 64°30' E	271'
49-50	N 03°30' E	369'
50-51	N 69°40' E	811'
51-52	N 82°00' W	353'
52-53	N 12°00' E	320'
53-54	N 86°55' E	75'
54-55	N 42°30' E	475'
55-56	N 83°00' W	1129'
56-57	N 63°00' E	396'
57-58	S 84°00' E	456'
58-59	N 40°00' W	690'
59-60	S 82°00' E	310'
60-61	N 15°00' W	627'
61-62	N 52°00' E	285'
62-63	S 35°00' E	175'
63-64	S 35°00' E	730'
64-65	N 58°00' E	510'
65-66	S 11°00' W	110'
66-67	S 19°30' W	680'
67-68	N 37°00' E	820'
68-69	N 67°00' E	392'
69-70	S 60°00' E	336'
70-71	S 62°30' W	450'
71-72	S 05°15' W	380'
72-73	S 70°00' W	200'
73-74	S 04°30' E	240'
74-75	S 31°00' W	600'
75-76	S 72°15' E	410'
76-77	S 37°00' W	150'
77-78	S 59°00' W	255'
78-79	S 46°45' E	220'
79-80	N 83°00' E	530'
80-81	N 81°00' E	200'
81-82	S 37°30' W	660'
82-83	S 81°45' E	184'
83-84	N 49°30' E	708'
84-85	N 68°00' E	474'
85-86	S 10°30' W	276'
86-87	S 22°00' W	410'
87-88	S 41°45' W	1020'
88-89	N 85°30' E	500'
89-90	S 48°00' E	300'
90-91	S 60°30' W	330'
91-92	S 05°45' E	370'
92-93	N 56°15' E	465'
93-94	S 49°30' E	360'
94-95	N 22°00' E	130'
95-96	N 74°02' E	610'
96-97	S 28°30' W	400'
97-98	S 32°00' W	365'

From - To	Bearing	Distance
98-99	S 21°00' E	180'
99-100	S 86°00' W	170'
100-101	S 65°59' W	300'
101-102	N 81°30' W	460'
102-103	S 44°00' E	310'
103-104	S 20°00' W	270'
104-105	S 90°00' W	300'
105-106	S 39°09' E	175'
106-107	S 41°32' E	209'
107-108	N 73°00' E	230'
108-109	S 64°00' E	120'
109-110	S 70°00' E	183'
110-111	N 26°00' E	120'
111-112	S 56°30' E	320'
112-113	N 40°00' E	557'
113-114	S 24°00' E	762'
114-115	S 57°00' W	90'
115-116	S 57°00' W	360'
116-117	S 72°00' E	270'
117-118	S 71°01' E	260'
119-120	S 40°00' W	494'
120-121	S 38°30' E	22'

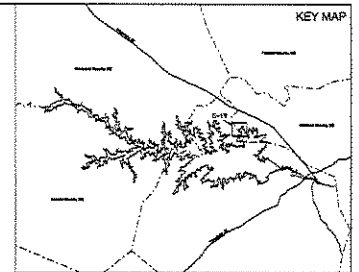
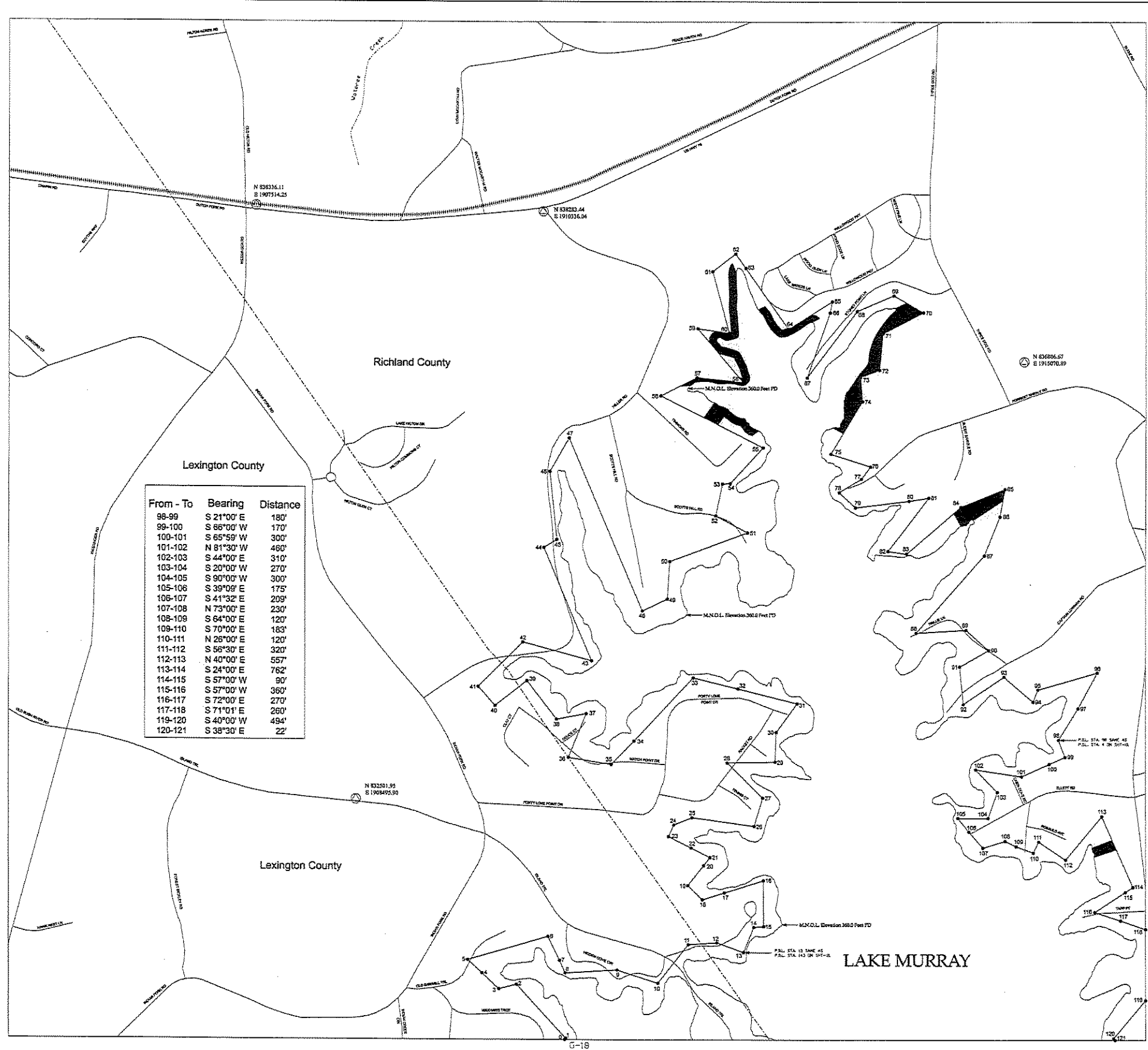

LEGEND

- Railroad
- Pipeline
- Transmission line
- Road
- Project Boundary Line
- Maximum Normal Operating Level (M.N.O.L.)
- Stream
- County Boundary
- Property owned in Fee by S.C.E. & G.
- ▨ Recreation areas owned in Fee by S.C.E. & G.

HORIZONTAL DATUM BASED ON THE SOUTH CAROLINA STATE PLANS COORDINATE SYSTEM NA83/2001 (INTERNATIONAL FOOT).

VERTICAL DATUM BASED ON NAVD83 (FEET).

TO CONVERT FROM S.C.E. & G. PLANT DATUM (PD) TO NAVD83 AND "01.9", THE PROJECT BOUNDARY HEREIN IS DEFINED BASED ON S.C.E. & G. SURVEYS AND RECORDS SURVEYS AND DEEDS OF RECORD UNLESS OTHERWISE NOTED. ALL AREAS OF THE PROJECT BOUNDARY THAT ARE SHOWN CONTAINING HEREIN PROVIDED BY S.C.E. & G. AND MARKED BY CROSS, "X".

STEREOCOMPILED PROCESS IN ACCORDANCE WITH NATIONAL MAP ACCURACY STANDARDS. AERIAL PHOTOGRAPHY WAS FLOWN AT A SCALE APPROXIMATELY 1:10000.

I, GERRARD BERGMAN, A PROFESSIONAL SOUTH CAROLINA PHOTOGRAMMETRIC SURVEYOR/HOTELER HAVE REVIEWED THE LAND SURVEY PROJECT HEREIN, THE PLANIMETRIC AND CONTIGUOUS SHOWN ON SAID MAPS ARE IN ACCORDANCE WITH THE NATIONAL MAP ACCURACY STANDARDS FOR THE SCALE OF 1"=400' AND WERE PRODUCED USING PHOTOGRAMMETRIC METHODS UNDER MY DIRECT SUPERVISION, ALL WORK IS BASED ON NA83/2001 SOUTH CAROLINA STATE PLANS COORDINATE SYSTEM (INTERNATIONAL FOOT) AND THE VERTICAL DATUM IS NAVD83 (FEET).

THIS DOCUMENT WAS ORIGINALY ISSUED AND SEALED BY GERRARD BERGMAN, L-14423, ON JULY 2, 2009. THIS MEDIA SHALL NOT BE CONSIDERED A CERTIFIED DOCUMENT.

I, GARY EATON, A PROFESSIONAL LAND SURVEYOR IN THE STATE OF SOUTH CAROLINA P.L.S. 12183, HAVE REVIEWED THIS PORTION OF THE LAND SURVEY PROJECT SHOWN HEREIN, THE LINEAR DISTANCES SHOWN IN THE SURVEY OR POSSESSION PLANS CALCULATED OVER THE LANDS SHOWN ON THIS MAP THAT ARE WITHIN THE PROJECT BOUNDARY. THIS PROJECT BOUNDARY LINES THAT ARE NOT CONTROL LINES WERE BASED ON S.C.E. & G. SURVEYS AND RECORDS SURVEYS AND DEEDS OF RECORD.

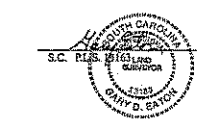

EXHIBIT G SHEET G-19

DETAIL MAP OF PROJECT AREA
SHEET 19 OF 77
SALUDA HYDROELECTRIC PROJECT NO. 516
SOUTH CAROLINA ELECTRIC & GAS COMPANY

SCALE: 1 INCH = 400 FEET

0 400 800 1,600
FEET

DATE: AUGUST 2009