

Project Boundary Line Traverse		
From - To	Bearing	Distance
0-1	N 22°00' E	103'
1-2	N 74°02' E	610'
2-3	S 28°30' W	400'
3-4	S 32°00' W	365'
4-5	S 21°00' E	180'
5-6	S 66°00' W	170'
6-7	S 65°59' W	164'
7-8	N 25°00' E	103'
8-9	S 55°30' E	320'
9-10	N 40°00' E	557'
10-11	S 24°00' E	762'
11-12	S 57°00' W	90'
12-13	S 57°00' W	360'
13-14	S 72°00' E	270'
14-15	S 71°01' E	390'
15-16	S 03°00' W	550'
16-17	S 40°00' W	640'
17-18	S 38°30' E	410'
18-19	S 83°00' E	460'
19-20	S 02°00' E	300'
20-21	N 89°30' E	660'
21-22	S 04°00' E	90'
22-23	S 43°00' W	580'
23-24	S 34°00' E	375'
24-25	S 25°00' W	240'
25-26	S 86°00' W	235'
26-27	S 14°00' E	460'
27-28	S 85°00' E	300'
28-29	N 09°00' E	200'
29-30	N 78°30' E	50'
30-31	N 78°30' E	760'
31-32	N 13°15' W	215'
32-33	N 54°00' W	745'
33-34	N 59°00' E	514'
34-35	S 70°10' E	365'
35-36	N 50°05' E	200'
36-37	N 64°50' W	730'
37-38	N 13°00' W	670'
38-39	S 68°00' E	360'
39-40	N 06°15' W	440'
40-41	S 78°00' W	128'
41-42	N 51°30' W	914'
42-43	N 72°15' E	794'
43-44	N 22°00' E	380'
44-45	S 67°30' W	500'
45-46	N 77°00' W	818'
46-47	N 53°00' E	593'
47-48	N 61°00' W	610'
48-49	N 49°00' E	305'
49-50	N 29°30' W	280'
50-51	N 77°00' E	240'
51-52	S 62°00' E	400'
52-53	N 18°30' W	950'
53-54	N 65°00' E	115'
54-55	S 59°30' E	818'
55-56	EL 362.00'	5027'
56-57	S 51°00' E	521'
57-58	S 12°30' W	500'
58-59	S 14°45' E	175'
59-60	S 86°00' E	335'
60-61	S 17°00' W	375'
61-62	S 81°00' E	300'
62-63	S 32°00' W	290'
63-64	S 27°00' E	300'
64-65	N 80°00' E	610'
65-66	S 28°00' W	870'
66-67	N 78°00' E	811'
67-68	S 20°00' W	592'
68-69	S 86°00' E	280'
69-70	S 11°00' W	760'
70-71	S 09°00' W	230'
71-72	N 86°00' E	650'
72-73	S 15°00' W	800'
73-74	N 85°00' E	550'
74-75	N 16°00' E	220'
75-76	N 67°00' E	420'
76-77	N 31°00' W	430'
77-78	N 90°00' E	620'
78-79	N 17°00' W	590'
79-80	N 65°00' E	100'
80-81	N 30°00' W	440'
81-82	S 78°00' W	170'
82-83	S 78°00' W	420'
83-84	N 48°00' W	650'
84-85	N 61°00' E	270'
85-86	N 55°00' E	248'
86-87	N 78°00' W	559'
87-88	N 57°00' E	675'
88-89	N 70°00' W	550'
89-90	N 51°00' E	650'
90-91	N 55°00' W	525'
91-92	N 78°00' E	480'
92-93	N 08°59' W	862'
93-94	N 86°00' E	310'
94-95	N 11°00' E	655'
95-96	S 68°22' E	589'
96-97	S 02°30' E	1308'

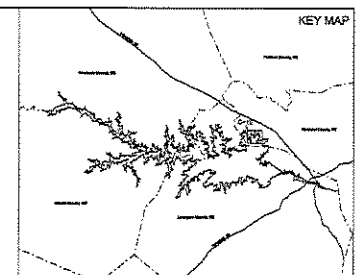
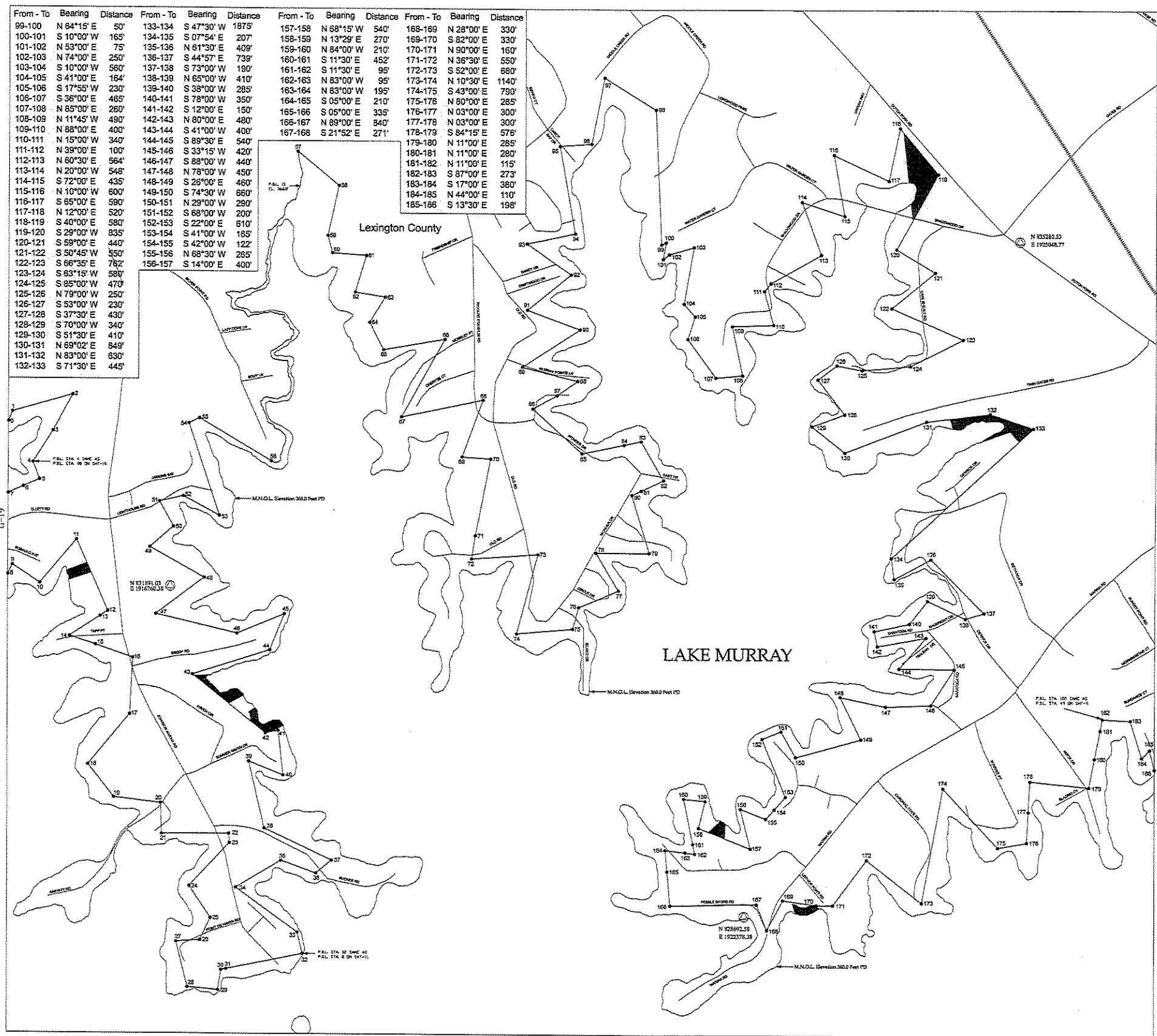

LEGEND

- Railroad
- Pipeline
- Transmission line
- Road
- Project Boundary Line
- Maximum Normal Operating Level (M.N.O.L.)
- Stream
- County Boundary
- Property owned in Fee by S.C.E. & G.
- ▨ Recreation areas owned in Fee by S.C.E. & G.

HORIZONTAL DATUM BASED ON THE SOUTH CAROLINA STATE PLANE COORDINATE SYSTEM (NAD83/2011) (INTERNATIONAL FOOT).

VERTICAL DATUM BASED ON NAVD83 (FEET).

TO CONVERT FROM S.C.E. & G. PLANT GATE (PG) TO NAVD 88 AND -11.5'. THE PROJECT BOUNDARY HEREIN IS DEFINED BASED ON S.C.E. & G. SURVEYS AND RECORDED SURVEYS AND DEEDS OF RECORD UNLESS OTHERWISE NOTED. ALL ANGLES OF THE PROJECT BOUNDARY THAT ARE ELEVATION CONTROLLED WERE PROVIDED BY S.C.E. & G. AND MARKED BY CROSS, INC.

STEREOREDUCTION PROCESS IN ACCORDANCE WITH NATIONAL MAP ACCURACY STANDARDS, AERIAL PHOTOGRAPHY WAS PLANNED AT A SCALE APPROXIMATELY 1:2000 - 600000.

I, GERARD SEBASTIAN, A PROFESSIONAL SOUTH CAROLINA PHOTOGRAMMETRIC SURVEYOR/HOTELER HAS REVIEWED THE LARGE SCALE PROJECT MAPS, THE PHOTOGRAPHIC AND CONTROL POINTS SHOWN ON SAID MAPS AND IN ACCORDANCE WITH THE NATIONAL MAP ACCURACY STANDARDS FOR THE SCALE OF 1"=100' AND WERE PRODUCED USING PHOTOGRAMMETRIC METHODS UNDER MY DIRECT SUPERVISION. ALL WORK IS BASED ON NAD83/2011 SOUTH CAROLINA STATE PLANE COORDINATE SYSTEM (INTERNATIONAL FOOT) AND THE VERTICAL DATUM IS NAVD83 (FEET).

THIS DOCUMENT WAS ORIGINALLY ISSUED AND SEALED BY GERARD SEBASTIAN, S.C.P.S. 11403, ON JULY 2, 2009. THIS MEDIA SHALL NOT BE CONSIDERED A CERTIFIED DOCUMENT.

I, DARY BAYON, A PROFESSIONAL LAND SURVEYOR IN THE STATE OF SOUTH CAROLINA (S.C.P.S. 12161), HAVE REVIEWED THIS PORTION OF THE LAKE MURRAY PROJECT BOUNDARY HEREIN. THE ACCURACY EXTENDS ONLY TO THE SURVEY OR POSSESSION PLUMBE RECORDED OVER THE LANDS SHOWN ON THIS MAP THAT ARE INSIDE THE PROJECT BOUNDARY. THE PROJECT BOUNDARY LINES THAT ARE NOT CONTROL LINES WERE BASED ON S.C.E. & G. SURVEYS AND RECORDED SURVEYS AND DEEDS OF RECORD.

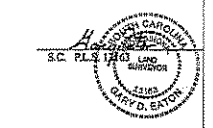
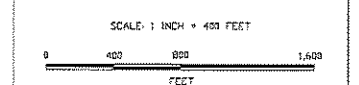

EXHIBIT G SHEET G-10

DETAIL MAP OF PROJECT AREA
SHEET 10 OF 77
SALUDA HYDROELECTRIC PROJECT NO. 516
SOUTH CAROLINA ELECTRIC & GAS COMPANY



DATE: AUGUST 2008