

**Project Boundary Line Traverse**

From - To	Bearing	Distance
0-1	S 01°32' W	169'
1-2	N 63°02' E	372'
3-4	S 09°25' E	697'
4-5	S 45°05' W	307'
5-6	S 62°25' E	420'
6-7	S 20°55' E	340'
7-8	S 28°20' W	610'
8-9	N 75°50' E	545'
9-10	S 43°40' E	560'
10-11	S 52°50' W	252'
11-12	S 53°10' E	530'
12-13	S 38°05' W	480'
13-14	N 80°10' W	615'
14-15	S 15°40' E	500'
15-16	S 42°20' W	1300'
16-17	N 76°50' E	693'
17-18	N 59°20' E	630'
18-19	N 07°40' W	365'
19-20	N 79°50' E	477'
20-21	S 27°55' E	830'
21-22	N 08°20' E	630'
22-23	N 78°05' E	210'
23-24	S 52°10' E	595'
24-25	S 19°50' W	420'
25-26	N 88°05' E	235'
26-27	S 46°20' W	370'
27-28	N 87°50' E	235'
28-29	S 43°40' E	490'
29-30	S 43°50' W	227'
30-31	S 81°40' E	355'
31-32	S 37°10' E	593'
32-33	S 40°50' W	610'
33-34	S 68°40' E	330'
34-35	N 29°05' E	247'
35-36	N 57°50' E	360'
36-37	S 62°10' E	437'
37-38	S 02°50' W	250'
38-39	N 54°20' E	290'
39-40	S 73°40' E	570'
40-41	S 85°10' E	270'
41-42	S 12°10' E	390'
42-43	S 82°10' E	635'
43-44	S 00°10' E	441'
44-45	S 63°50' W	973'
45-46	S 72°50' W	803'
46-47	S 62°50' W	537'
47-48	S 58°20' W	280'
48-49	N 87°25' W	320'
49-50	S 45°10' W	652'
50-51	S 45°10' W	283'
51-52	N 72°45' W	117'
52-53	S 70°50' W	275'
53-54	S 69°55' E	299'
54-55	N 84°50' E	139'
55-56	N 87°40' E	166'
56-57	N 34°35' E	222'
57-58	N 64°05' E	184'
58-59	N 83°50' E	296'
59-60	S 08°00' E	161'
60-61	S 30°10' E	134'
61-62	S 17°50' W	300'
62-63	N 21°50' E	365'
63-64	N 24°10' W	163'
64-65	N 38°20' E	63'
65-66	N 44°05' E	380'
66-67	N 72°20' E	590'
67-68	S 44°40' E	410'
68-69	N 37°20' E	610'
69-70	N 87°20' E	450'
70-71	S 85°10' E	520'
71-72	S 00°50' W	582'
72-73	N 67°50' E	320'
73-74	N 19°30' E	233'
74-75	N 15°40' W	325'
75-76	N 01°05' E	305'
76-77	N 68°35' E	163'
77-78	N 08°50' E	380'
78-79	N 48°10' W	100'
79-80	N 35°50' E	204'
80-81	N 70°20' E	435'
81-82	N 73°35' E	130'
82-83	S 41°00' E	600'
83-84	S 58°40' E	340'
84-85	S 30°55' E	384'
85-86	S 52°35' W	282'
86-87	S 64°10' E	430'
88-89	S 47°20' W	660'
89-90	S 82°25' E	490'
91-92	N 72°00' W	772'
92-93	N 72°00' W	1080'
93-94	N 84°30' W	500'
94-95	N 35°00' W	1522'
95-96	N 70°00' W	1464'
96-97	N 10°00' E	838'
97-98	S 66°00' W	492'
98-99	N 77°35' W	867'
99-100	N 38°30' W	416'
100-101	N 00°00' E	889'

From - To	Bearing	Distance
101-102	N 31°25' E	648'
102-103	N 42°25' W	255'
103-104	S 38°30' W	270'
104-105	S 70°00' W	288'
105-106	N 23°59' W	835'
106-107	N 03°00' W	13'
107-108	S 77°16' E	6493'
108-109	S 69°30' W	1189'
109-110	S 69°30' E	1452'
110-111	S 61°30' E	596'
111-112	N 62°00' E	397'

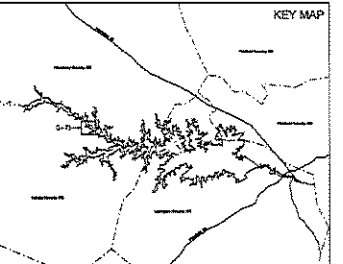
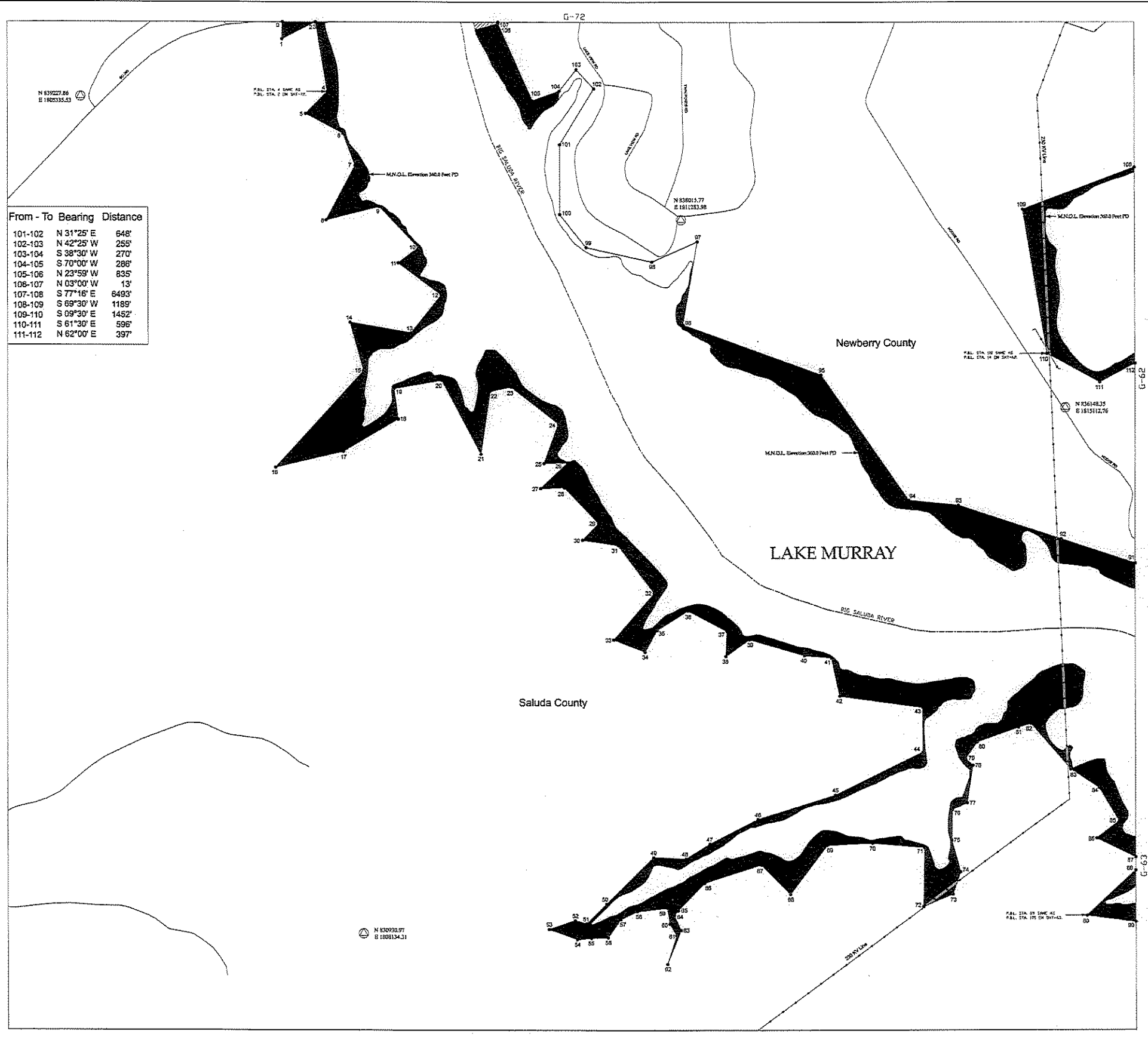

**LEGEND**

- Railroad
- Pipeline
- Transmission line
- Road
- Project Boundary Line
- Maximum Normal Operating Level (M.N.O.S.L.)
- Stream
- County Boundary
- Property owned in Fee by S.C.E. & G.
- ▨ Recreation areas owned in Fee by S.C.E. & G.

HORIZONTAL DATUM BASED ON THE SOUTH CAROLINA STATE PLANE COORDINATE SYSTEM NAD83/2011 (INTERNATIONAL FOOT).  
 VERTICAL DATUM BASED ON NAVD83 (FEET).  
 TO CONVERT FROM S.C.E. & G. PLANT DATUM (1981) TO NAVD83 USE EQUATION:  $Y = 0.999999999 X + 0.000000001$ . THE PROJECT BOUNDARY HEREIN IS REFERRED BASED ON S.C.E. & G. SURVEYS AND RECORDED SURVEYS AND DEEDS OF RECORD UNLESS OTHERWISE NOTED. ALL AREAS OF THE PROJECT BOUNDARY THAT ARE ELEVATION CONTROLLED WERE PROVIDED BY S.C.E. & G. AND MAINTAINED BY OASIS, INC.  
 STEREOCOMPARISON PERFORMED IN ACCORDANCE WITH NATIONAL MAP ACTING STANDARDS. AERIAL PHOTOGRAPHY WAS TAKEN AT A SCALE APPROXIMATELY 1 INCH = 600 FEET.

I, GERRARD SEMMEL, A PROFESSIONAL SURVEYOR IN THE STATE OF SOUTH CAROLINA, HAVE REVIEWED THE PHOTOGRAMMETRIC SURVEYS AND MAPS FOR THE LAKE MURRAY PROJECT MAPS. THE PLANIMETRIC AND CONTOUR DATA SHOWN ON SAID MAPS ARE IN ACCORDANCE WITH THE NATIONAL MAP ACTING STANDARDS FOR THE SCALE OF 1"=150' AND WERE PRODUCED USING PHOTOGRAMMETRIC METHODS UNDER MY DIRECT SUPERVISION. ALL WORK IS BASED ON RECORDED SOUTH CAROLINA STATE PLANE COORDINATE SYSTEM (INTERNATIONAL FOOT) AND THE VERTICAL DATUM IS NAVD83 (FEET).  
 THIS DOCUMENT WAS ORIGINALLY ISSUED AND SEALED BY GERRARD SEMMEL, L-14133, ON JULY 2, 2008. THIS MEDIA SHALL NOT BE CONSIDERED A CERTIFIED DOCUMENT.



EXHIBIT G SHEET G-71

DETAIL MAP OF PROJECT AREA  
 SHEET 71 OF 77  
 SALUDA HYDROELECTRIC PROJECT NO. 516  
 SOUTH CAROLINA ELECTRIC & GAS COMPANY

