

Project Boundary Line Traverse

From - To	Bearing	Distance
0-1	N 59°30' E	227'
1-2	N 01°15' W	795'
2-3	N 25°00' E	170'
3-4	S 65°00' E	270'
4-5	S 43°15' E	485'
5-6	S 74°45' E	485'
6-7	N 04°30' W	140'
7-8	N 59°00' E	857'
8-9	N 51°15' E	1654'
9-10	S 22°00' W	825'
10-11	S 17°00' E	420'
11-12	S 69°53' E	339'
12-13	N 26°00' E	700'
13-14	N 33°44' E	1631'
14-15	S 09°30' W	761'
15-16	S 80°00' E	400'
16-17	N 21°30' E	735'
17-18	N 72°00' E	730'
18-19	S 32°15' E	520'
19-20	N 81°31' E	280'
20-21	N 01°30' W	350'
21-22	N 79°00' E	363'
22-23	N 13°40' W	299'
23-24	N 69°30' E	1207'
24-25	S 02°43' E	378'
25-26	S 71°00' W	360'
26-27	S 21°00' W	865'
27-28	N 78°40' W	300'
28-29	S 20°00' W	913'
29-30	S 50°45' W	500'
30-31	S 01°37' E	616'
31-32	S 79°15' E	450'
32-33	S 14°00' W	400'
33-34	S 85°00' E	140'
34-35	S 06°30' W	162'
35-36	S 15°30' E	148'
37-38	N 19°00' E	296'
38-39	N 75°00' W	851'
39-40	S 33°15' W	170'
40-41	N 16°00' W	390'
41-42	N 73°30' W	370'
42-43	N 23°00' W	535'
43-44	S 58°30' E	760'
44-45	N 49°30' E	580'
45-46	S 85°45' E	670'
46-47	N 31°00' E	984'
48-49	N 51°00' W	480'
49-50	N 50°30' E	297'
50-51	S 52°15' E	162'
52-53	S 78°45' W	473'
53-54	N 59°50' W	860'
54-55	S 19°00' E	732'
55-56	S 44°00' W	230'
56-57	S 24°00' W	635'
57-58	N 28°30' W	1022'
58-59	N 46°00' E	365'
59-60	N 43°30' W	580'
60-61	S 67°00' W	670'
61-62	S 83°00' W	380'
62-63	N 46°00' E	755'
63-64	N 65°00' W	810'
64-65	S 47°30' W	560'
65-66	N 45°45' W	480'
66-67	S 87°30' W	465'
67-68	S 53°30' W	590'
68-69	S 81°30' W	785'
69-70	N 02°48' E	210'
70-71	S 53°28' W	269'
71-72	S 01°52' W	550'
72-73	N 78°56' E	154'
73-74	S 07°30' E	640'
74-75	S 85°30' W	395'
75-76	N 14°30' W	518'
76-77	N 12°00' E	520'
77-78	N 42°00' W	300'
78-79	N 32°00' W	715'
79-80	S 13°00' W	1037'
80-81	N 87°45' W	450'
81-82	N 15°00' E	328'
82-83	N 24°00' W	540'
83-84	S 26°30' W	877'
84-85	N 87°45' W	350'
85-86	N 36°30' W	293'
86-87	S 14°00' W	225'
87-88	S 05°00' W	505'
88-89	N 46°30' W	810'
89-90	N 84°14' W	324'
90-91	N 45°00' E	620'
91-92	N 06°00' E	1577'
92-93	N 82°00' E	270'
93-94	N 48°00' W	380'
94-95	S 72°00' W	1120'
95-96	S 25°00' E	870'
96-97	S 31°30' W	860'
97-98	N 75°00' W	550'
98-99	S 02°00' W	340'
99-100	S 31°00' E	300'
100-101	S 45°00' E	1145'

From - To	Bearing	Distance
101-102	S 05°00' E	481'
102-103	S 68°15' W	783'
103-104	S 03°30' E	590'
104-105	S 71°00' W	785'
105-106	N 23°15' W	787'
107-108	N 87°30' W	15'
108-109	S 18°30' W	600'
109-110	S 74°50' W	180'
110-111	S 51°50' W	480'
111-112	S 32°45' E	480'
112-113	S 32°45' E	455'
113-114	S 45°15' E	352'

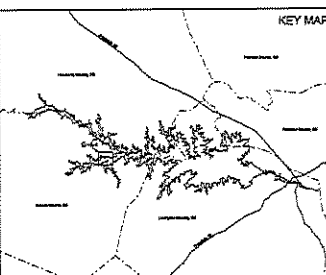
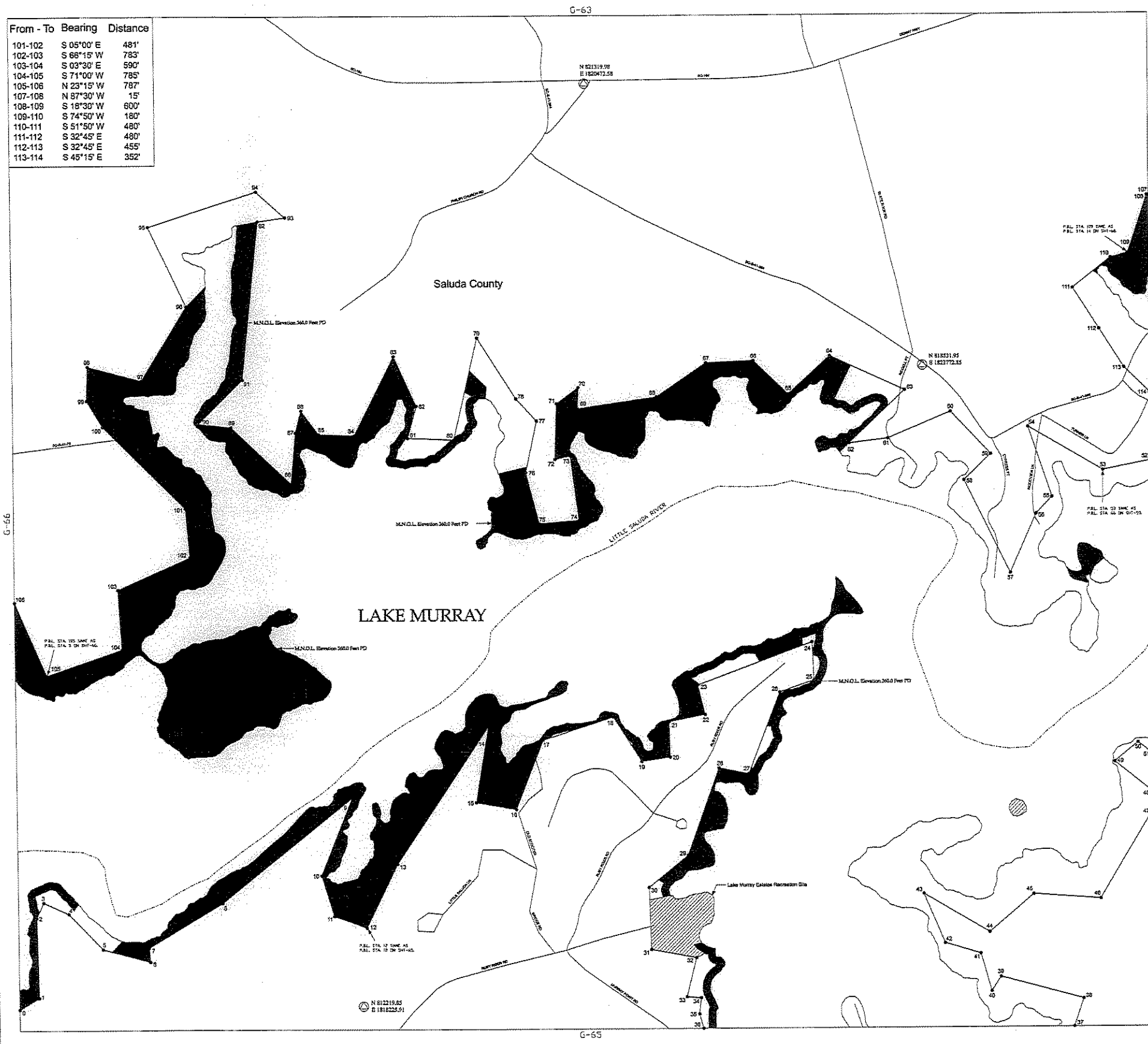

LEGEND

- Road
- Pipeline
- Transmission line
- Road
- Project Boundary Line
- Maximum Normal Operating Level (M.N.O.L.)
- Stream
- County Boundary
- Property owned in Fee by S.C.E. & G.
- ▨ Recreation areas owned in Fee by S.C.E. & G.

HORIZONTAL DATUM BASED ON THE SOUTH CAROLINA STATE PLANNING COORDINATE SYSTEM (NAD83/2011 INTERNATIONAL FOOT).

VERTICAL DATUM BASED ON NAVD83 (FEET).

TO CONVERT FROM S.C.E. & G. PLANNING DATUM (FD) TO NAVD83 AND -81.3', THE PROJECT BOUNDARY HEIGHT IS DECREASED BASED ON S.C.E. & G. SURVEYS AND RECORDED SURVEYS AND DEEDS OF RECORD (SEEDEED CHANGES NOTES). ALL AREAS OF THE PROJECT BOUNDARY THAT ARE ELEVATION CONTOURS WERE PROVIDED BY S.C.E. & G. AND MAPPED BY ORSIS, INC.

INTERPOLATION PROCESS IS ACCORDANCE WITH NATIONAL MAP ACCURACY STANDARDS. AERIAL PHOTOGRAPHY WAS FLOWN AT A SCALE APPROXIMATELY 1 INCH = 600 FEET.

I, GERARD SEHMALEK, A PROFESSIONAL SOUTH CAROLINA PHOTOGRAMMETRIC SURVEYOR/MASTER HAVE REVIEWED THE LAKE MURRAY PROJECT MAPS. THE PLANIMETRIC AND CONTOUR SURVEYS OF SAID MAPS ARE IN ACCORDANCE WITH THE NATIONAL MAP ACCURACY STANDARDS FOR THE SCALE OF 1"=100' AND WERE PRODUCED USING PHOTOGRAMMETRIC METHODS UNDER MY DIRECT SUPERVISION. ALL WORK IS BASED ON NAD83/2011 SOUTH CAROLINA STATE PLANNING COORDINATE SYSTEM (INTERNATIONAL FOOT) AND THE VERTICAL DATUM IS NAVD83 (FEET).

THIS DOCUMENT WAS ORIGINALLY ISSUED AND SEALED BY GERARD SEHMALEK, L-24623, ON JULY 2, 2008. THIS MEDIA DIGITAL COPY IS CONSIDERED A CERTIFIED COPY.

I, GARY DIXON, A PROFESSIONAL LAND SURVEYOR IN THE STATE OF SOUTH CAROLINA P.L.S. 12145, HAVE REVIEWED THIS PORTION OF THE LAKE MURRAY PROJECT BOUNDARY FROM HEREIN. THE LICENSEE EITHER OWNS IN FEE SIMPLE OR POSSESSES FLOODING EASEMENTS OVER THE LANDS SHOWN ON THIS MAP THAT ARE WITHIN THE PROJECT BOUNDARY. THE PROJECT BOUNDARY LINES THAT ARE NOT CONTOUR LINES WERE BASED ON S.C.E. & G. SURVEYS AND RECORDED SURVEYS AND DEEDS OF RECORD.

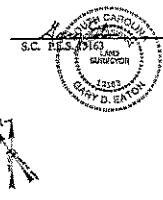

EXHIBIT G SHEET G-64

DETAIL MAP OF PROJECT AREA
SHEET 64 OF 77
SALUDA HYDROELECTRIC PROJECT NO. 516
SOUTH CAROLINA ELECTRIC & GAS COMPANY

SCALE: 1 INCH = 400 FEET

0 400 800 1,600
FEET

DATE: AUGUST 2008