

Project Boundary Line Traverse		
From - To	Bearing	Distance
0-1	N 41°00' W	184'
1-2	S 72°00' E	255'
2-3	S 72°00' E	775'
3-4	S 53°29' E	1720'
4-5	N 58°00' E	385'
5-6	N 42°00' W	598'
6-7	N 01°30' W	912'
7-8	N 10°00' W	818'
8-9	N 01°30' W	811'
9-10	N 04°30' W	546'
10-11	N 65°00' W	536'
11-12	S 62°00' W	450'
12-13	N 61°30' W	598'
13-14	N 09°30' W	618'
14-15	N 69°30' E	1880'
15-16	N 27°30' W	623'
16-17	N 27°30' W	280'
17-18	N 53°00' W	935'
18-19	N 00°00' E	745'
19-20	N 37°00' W	639'
20-21	N 20°00' E	418'
21-22	S 26°00' W	552'
22-23	S 05°45' W	660'
23-24	S 76°05' E	637'
24-25	S 18°00' E	548'
25-26	S 57°30' E	900'
26-27	N 53°45' E	480'
27-28	N 69°30' E	760'
28-29	S 19°00' E	160'
29-30	S 62°00' W	815'
30-31	S 15°00' E	1105'
31-32	S 73°00' E	750'
32-33	S 52°30' W	295'
33-34	S 57°00' W	260'
34-35	S 33°00' E	116'
35-36	S 09°30' W	51'
36-37	N 67°00' W	205'
37-38	N 75°30' W	140'
38-39	S 24°30' W	395'
39-40	S 62°00' E	140'
40-41	S 48°30' W	425'
41-42	S 28°00' E	245'
42-43	N 60°30' W	478'
43-44	S 24°30' W	590'
44-45	S 82°30' E	370'
45-46	S 35°00' E	405'
46-47	S 74°30' E	570'
47-48	S 57°00' W	450'
48-49	S 12°54' W	720'
49-50	N 82°30' E	897'
50-51	S 55°15' W	870'
51-52	S 06°00' E	215'
52-53	N 71°30' E	911'
53-54	S 04°45' W	495'
54-55	S 30°00' E	115'
55-56	S 77°00' W	851'
56-57	S 38°00' W	385'
57-58	S 62°30' E	750'
58-59	N 59°00' E	855'
59-60	S 36°15' E	340'
60-61	S 54°45' W	640'
61-62	S 45°05' E	717'
62-63	S 27°45' E	570'
63-64	S 05°30' E	384'
64-65	N 29°00' E	493'
65-66	N 37°15' E	500'
66-67	N 68°45' E	1045'
67-68	S 47°30' E	520'
68-69	N 53°00' E	505'
69-70	N 23°30' E	530'
70-71	N 60°00' W	509'
71-72	N 70°12' E	26'
72-73	N 79°02' E	375'
73-74	N 17°16' E	350'
74-75	N 15°37' W	816'
75-76	S 60°00' E	270'
76-77	N 54°00' E	470'
77-78	N 08°00' W	1727'
78-79	S 87°00' E	429'
79-80	S 16°30' E	1520'
80-81	N 58°00' E	507'
81-82	S 55°30' E	959'
82-83	S 79°45' E	1280'
83-84	N 22°15' E	231'
84-85	N 57°30' W	96'
85-86	S 85°00' W	780'
86-87	S 48°45' W	450'
87-88	S 11°00' W	355'
88-89	N 74°15' W	695'
89-90	S 48°15' W	315'
90-91	S 48°15' W	445'
91-92	S 02°00' W	982'
92-93	N 79°0' W	723'
93-94	S 30°00' E	217'

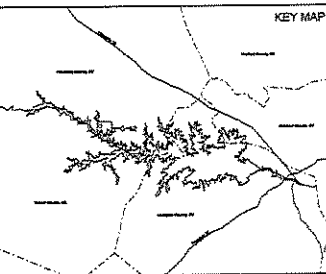
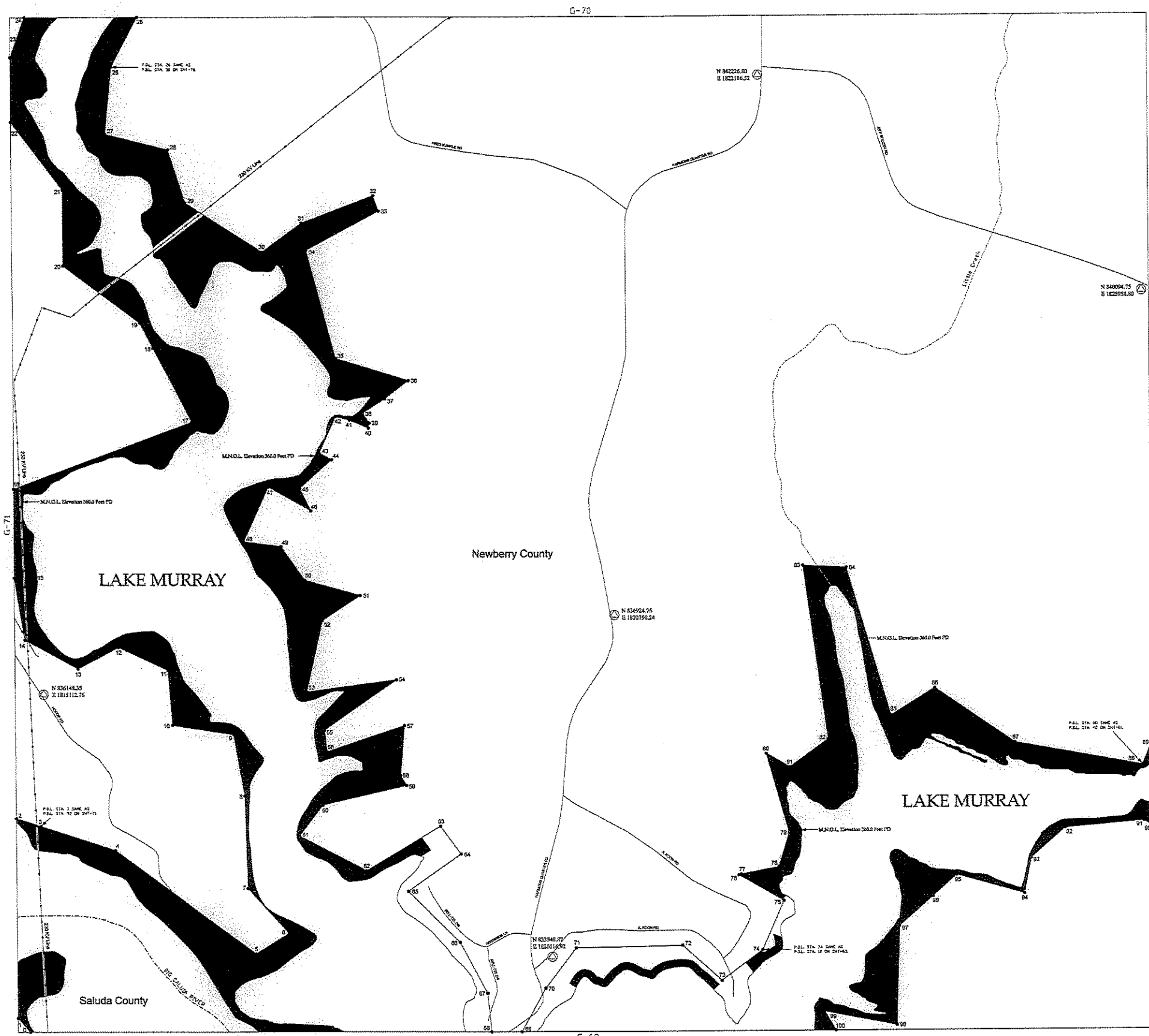

**LEGEND**

- Railroad
- Pipeline
- Transmission line
- Road
- Project Boundary Line
- Maximum Normal Operating Level (MNDL)
- Stream
- County Boundary
- Property owned in Fee by SCE & G.
- ▨ Recreation areas owned in Fee by SCE & G.

HORIZONTAL DATUM BASED ON THE SOUTH CAROLINA STATE PLANE COORDINATE SYSTEM NAD83/2011 (INTERNATIONAL FOOT).

VERTICAL DATUM BASED ON NAVD83 (FEET).

TO CONVERT FROM S.C.E. & G. PLANT DATUM (PD) TO NAVD83, ADD -01.5'. THE PROJECT BOUNDARY HEREIN IS DEFINED BASED ON S.C.E. & G. SURVEYS AND RECORDED SURVEYS AND DEEDS OF RECORD UNDER FORTWORTH DEEDS. ALL AREAS OF THE PROJECT BOUNDARY THAT ARE ELEVATION CONTOURS WERE PROVIDED BY S.C.E. & G. AND MAPPED BY CH2M HILL, INC.

STEREOCORRELATION PROCESS IN ACCORDANCE WITH NATIONAL MAP ACCURACY STANDARDS. AERIAL PHOTOGRAPHY WAS FLOWN AT A SCALE APPROXIMATELY 1 INCH = 400 FEET.

1. GERHARD ZERBALKER, A PROFESSIONAL SOUTH CAROLINA PHOTOGRAMMETRIC SURVEYOR/MAPPER HAS REVIEWED THE LARGE SCALE PROJECT MAP. THE DIMENSIONS AND COORDINATES SHOWN ON SAID MAPS ARE IN ACCORDANCE WITH THE NATIONAL MAP ACCURACY STANDARDS FOR THE SCALE OF 1"=400' AND WERE PRODUCED USING PHOTOGRAMMETRIC METHODS UNDER MY DIRECT SUPERVISION. ALL WORK IS BASED ON NAD83/2011 SOUTH CAROLINA STATE PLANE COORDINATE SYSTEM (INTERNATIONAL FOOT) AND THE VERTICAL DATUM IS NAVD83 (FEET).

THIS DOCUMENT WAS ORIGINALLY ISSUED AND DEALD BY GERHARD ZERBALKER, L-24625, ON JULY 2, 2008. THIS MEDIA SHALL NOT BE CONSIDERED A CERTIFIED DOCUMENT.

1. GARY BAYON, A PROFESSIONAL LAND SURVEYOR IN THE STATE OF SOUTH CAROLINA P.L.S. 13163, HAS REVIEWED THIS PORTION OF THE LARGE MURRAY PROJECT BOUNDARY SHOWN HEREIN. THE LICENSEE EITHER OWNS IN FEE SINGLE OR JOINT TENANT INTERESTS OVER THE LANDS SHOWN ON THIS MAP THAT ARE WITHIN THE PROJECT BOUNDARY. THE PROJECT BOUNDARY LINES THAT ARE NOT CONTOUR LINES WERE OBTAINED ON S.C.E. & G. SURVEYS AND RECORDED SURVEYS AND DEEDS OF RECORD.



EXHIBIT G SHEET G-62

DETAIL MAP OF PROJECT AREA  
SHEET 62 OF 77  
SALUDA HYDROELECTRIC PROJECT NO. 516  
SOUTH CAROLINA ELECTRIC & GAS COMPANY

SCALE: 1 INCH = 400 FEET

0 400 800 1,600  
FEET

DATE: AUGUST 2008