

Project Boundary Line Traverse		
From - To	Bearing	Distance
0-1	N 51°00' W	466'
1-2	N 81°00' E	451'
3-4	N 30°00' W	1109'
4-5	N 49°40' W	400'
5-6	N 31°15' W	515'
6-7	N 83°30' E	380'
7-8	N 48°30' W	465'
8-9	N 12°30' W	711'
9-10	N 81°00' E	159'
10-11	N 28°00' W	740'
11-12	N 10°30' E	310'
12-13	S 69°00' W	200'
13-14	S 23°00' W	875'
14-15	S 26°00' E	500'
15-16	S 15°15' W	500'
16-17	S 28°00' E	550'
17-18	S 69°15' W	175'
18-19	N 50°50' W	820'
19-20	N 80°15' W	390'
20-21	N 24°00' W	385'
21-22	N 74°00' W	405'
22-23	N 39°45' W	545'
23-24	N 14°30' E	625'
24-25	N 37°00' W	340'
25-26	N 02°20' W	450'
26-27	N 50°00' W	335'
27-28	S 05°00' E	1000'
28-29	S 15°30' W	369'
29-30	S 84°00' W	312'
30-31	N 30°30' W	1098'
31-32	N 37°30' E	430'
32-33	N 16°00' W	1380'
33-34	N 40°00' W	505'
34-35	S 68°30' W	200'
35-36	S 18°00' E	870'
36-37	S 87°30' W	615'
37-38	S 25°00' E	555'
38-39	S 11°30' W	960'
39-40	S 71°00' E	460'
40-41	S 14°00' E	1080'
41-42	S 86°00' E	455'
42-43	N 67°00' E	220'
43-44	S 46°30' E	775'
44-45	S 18°50' E	508'
45-46	S 55°20' E	2060'
46-47	S 55°20' E	120'
47-48	S 80°00' E	520'
48-49	S 42°30' E	985'
49-50	N 75°30' W	674'
50-51	S 24°30' W	619'
51-52	S 70°00' W	217'
52-53	N 53°30' W	320'
53-54	S 21°00' W	280'
54-55	S 70°00' W	405'
55-56	N 33°30' W	730'
56-57	S 13°00' W	530'
57-58	N 84°30' W	420'
58-59	S 05°15' E	560'
59-60	N 82°00' W	640'
60-61	N 30°15' W	580'
61-62	N 49°45' W	380'
62-63	N 16°00' E	240'
63-64	N 38°00' W	352'
64-65	S 31°30' W	575'
65-66	N 28°00' W	310'
66-67	N 03°30' E	690'
67-68	S 73°45' W	360'
68-69	N 03°30' E	400'
69-70	N 51°15' E	480'
70-71	N 57°00' W	1075'
71-72	N 30°50' W	754'
72-73	S 55°00' W	510'
73-74	S 50°00' E	125'
74-75	S 36°30' E	330'
75-76	S 07°45' E	660'
76-77	S 38°30' W	215'
77-78	S 34°00' E	347'
78-79	S 69°00' W	484'
79-80	S 61°30' E	561'
80-81	S 24°30' E	1098'
81-82	S 14°30' W	135'
82-83	S 30°30' E	420'
83-84	N 59°30' W	750'
84-85	N 59°30' W	178'
85-86	S 41°00' W	565'
86-87	N 07°00' W	565'
87-88	N 26°27' W	321'
88-89	N 40°00' W	220'
89-90	S 42°00' W	540'
90-91	N 59°00' W	550'
91-92	S 03°45' W	200'
92-93	S 18°45' E	1340'
93-94	S 51°00' W	820'
94-95	N 23°30' W	160'
95-96	S 77°00' W	60'
96-97	N 30°0' W	580'
97-98	N 00°00' E	170'
98-99	N 27°00' W	710'

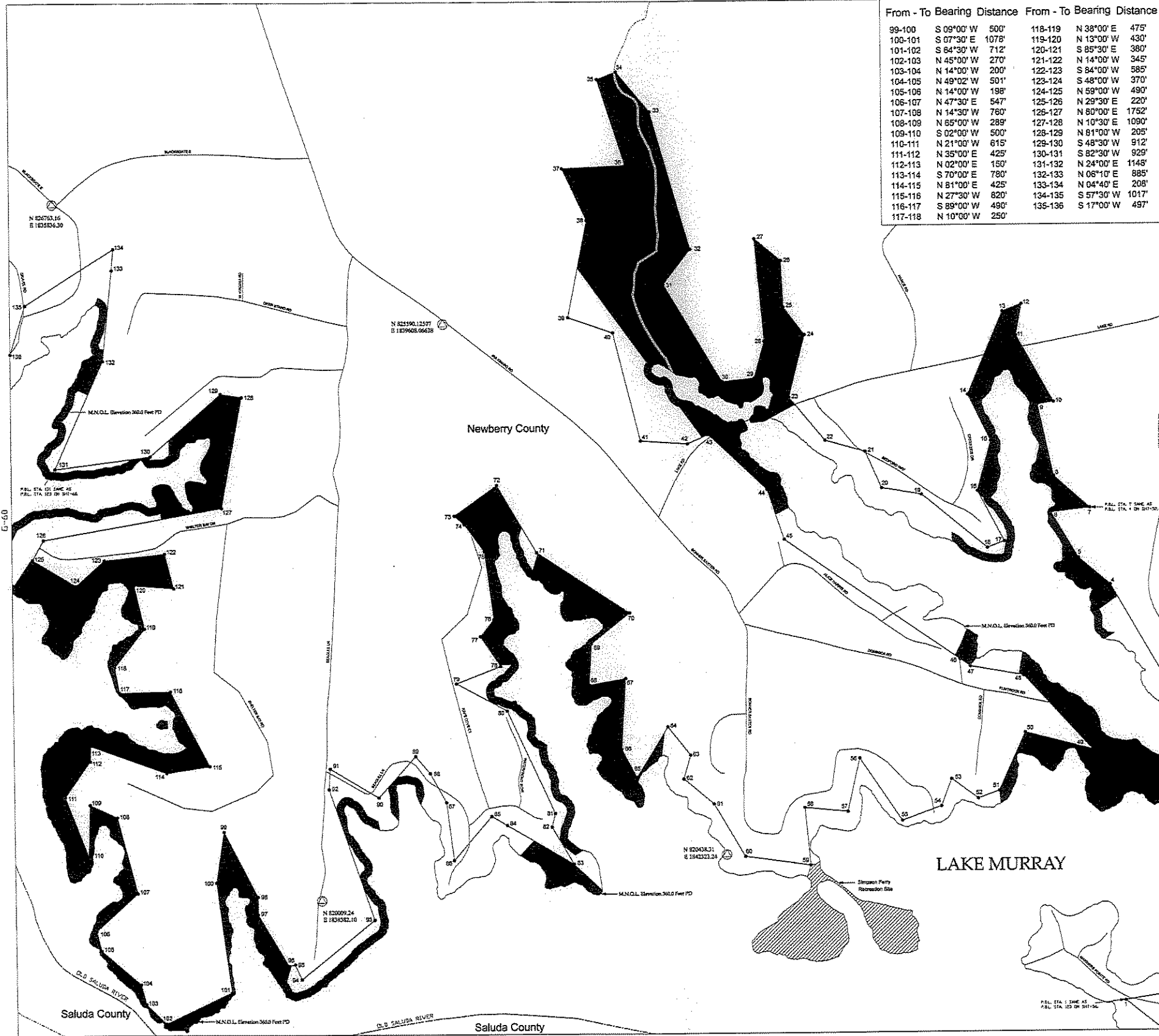

From - To	Bearing	Distance	From - To	Bearing	Distance
99-100	S 09°00' W	500'	118-119	N 38°00' E	475'
100-101	S 07°30' E	1078'	119-120	N 13°00' W	430'
101-102	S 64°30' W	712'	120-121	S 85°30' E	380'
102-103	N 45°00' W	270'	121-122	N 14°00' W	345'
103-104	N 14°00' W	200'	122-123	S 84°00' W	585'
104-105	N 49°02' W	501'	123-124	S 48°00' W	370'
105-106	N 14°00' W	198'	124-125	N 59°00' W	490'
106-107	N 47°30' E	547'	125-126	N 29°30' E	220'
107-108	N 14°30' W	760'	126-127	N 80°00' E	1752'
108-109	N 65°00' W	289'	127-128	N 10°30' E	1090'
109-110	S 02°00' W	500'	128-129	N 61°00' W	205'
110-111	N 21°00' W	615'	129-130	S 48°30' W	912'
111-112	N 35°00' E	425'	130-131	S 82°30' W	929'
112-113	N 02°00' E	150'	131-132	N 24°00' E	1148'
113-114	S 70°00' E	780'	132-133	N 08°10' E	885'
114-115	N 81°00' E	425'	133-134	N 04°40' E	208'
115-116	N 27°30' W	820'	134-135	S 57°30' W	1017'
116-117	S 89°00' W	490'	135-136	S 17°00' W	497'
117-118	N 10°00' W	250'			

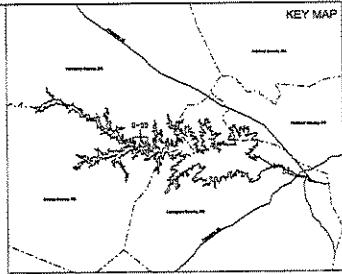

**LEGEND**

- Railroad
- Pipeline
- Transmission line
- Road
- Project Boundary Line
- Maximum Normal Operating Level (M.N.O.L.)
- Stream
- County Boundary
- Property owned in Fee by SCE & G
- Recreation areas owned in Fee by SCE & G

HORIZONTAL DATUM BASED ON THE SOUTH CAROLINA STATE PLANE COORDINATE SYSTEM 1883/2001 (INTERNATIONAL FOOT).

VERTICAL DATUM BASED ON NAVD83 (FEET).

TO CONVERT FROM S.C.E. & G. PLANT DATUM (PD) TO NAVD83 SEE ADD '01.2'. THE PROJECT BOUNDARY HEREIN IS DEFINED BASED ON S.C.E. & G. SURVEYS AND RECORDED SURVEYS AND DEEDS OF RECORD UNLESS OTHERWISE NOTED. ALL AREAS OF THE PROJECT BOUNDARY THAT ARE ELEVATION CONTOURS WERE PROVIDED BY S.C.E. & G. AND MARKED BY CROSS, INC.

STEREOREDUCTION PROCESS IN ACCORDANCE WITH NATIONAL MAP ACCURACY STANDARDS. AERIAL PHOTOGRAPHY WAS FLOWN AT A SCALE APPROXIMATELY 1:1000 = 400 FEET.

I, GERRARD BERNHARDT, A PROFESSIONAL SOUTH CAROLINA PHOTOGRAMMETRIC SURVEYOR/PATENT SURVEYOR REVIEWED THE LAKE MURRAY PROJECT MAPS. THE PLANIMETRIC AND CONTIGUOUS SURVEY OF SAID MAPS ARE IN ACCORDANCE WITH THE NATIONAL MAP ACCURACY STANDARDS FOR THE SCALE OF 1"=400' AND WERE PRODUCED USING PHOTOGRAMMETRIC METHODS UNDER MY DIRECT SUPERVISION. ALL WORK IS BASED ON 1883/2001 SOUTH CAROLINA STATE PLANE COORDINATE SYSTEM (INTERNATIONAL FOOT) AND THE VERTICAL DATUM IS NAVD83 (FEET).

THIS DOCUMENT WAS ORIGINALLY ISSUED AND SEALED BY GERRARD BERNHARDT, L-14433, ON JULY 3, 2009. THIS MEDIA SHALL NOT BE CONSIDERED A CERTIFIED DOCUMENT.

I, GARY DAVIS, A PROFESSIONAL LAND SURVEYOR IN THE STATE OF SOUTH CAROLINA P.L.S. 13163, HAVE REVIEWED THIS PORTION OF THE LAKE MURRAY PROJECT BOUNDARY SHOWN HEREIN. THE LICENSEE EITHER OWNS IN FEE SIMPLE OR POSSESSIVE PLUNGE EASEMENT OVER THE LARGE SHOWS OF THIS MAP THAT ARE OUTSIDE THE PROJECT BOUNDARY. THE PROJECT BOUNDARY LINES THAT ARE NOT CONTOUR LINES WERE BASED ON S.C.E. & G. SURVEYS AND RECORDED SURVEYS AND DEEDS OF RECORD.

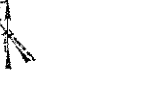

EXHIBIT G SHEET G-55

DETAIL MAP OF PROJECT AREA  
SHEET 55 OF 77  
SALUDA HYDROELECTRIC PROJECT NO. 516  
SOUTH CAROLINA ELECTRIC & GAS COMPANY

SCALE: 1 INCH = 400 FEET

0 400 800 1,600  
FEET

DATE: AUGUST 2009