

Project Boundary Line Traverse

From - To	Bearing	Distance
0-1	S 75°30' E	197'
1-2	N 42°30' W	282'
3-4	S 49°30' E	245'
4-5	S 83°30' W	185'
6-7	S 31°15' E	142'
7-8	S 49°40' E	400'
8-9	S 30°00' E	1159'
9-10	N 15°00' E	1917'
10-11	S 45°00' E	618'
11-12	N 49°50' E	414'
12-13	S 61°00' E	300'
13-14	S 22°30' W	630'
14-15	S 70°00' E	615'
15-16	S 64°30' W	1145'
16-17	S 43°30' E	470'
17-18	S 79°40' E	350'
18-19	N 74°00' E	500'
19-20	S 02°00' W	415'
21-22	S 58°30' W	1040'
22-23	S 80°00' E	451'
23-24	S 16°45' E	470'
24-25	S 88°18' W	785'
25-26	S 06°00' E	495'
26-27	N 67°30' E	549'
27-28	S 65°45' E	578'
28-29	S 42°45' W	505'
29-30	S 71°00' W	1021'
30-31	S 81°00' W	965'
31-32	S 51°00' E	800'
32-33	S 48°30' W	395'
33-34	S 69°15' E	1020'
34-35	S 43°00' W	340'
35-36	S 80°00' W	400'
36-37	S 48°30' E	600'
37-38	S 83°00' E	345'
38-39	N 85°00' E	400'
39-40	N 06°00' E	1280'
40-41	N 13°30' E	737'
41-42	S 50°00' E	1101'
42-43	S 02°00' W	230'
43-44	S 71°00' W	362'
44-45	S 01°00' W	781'
45-46	S 57°00' E	242'
46-47	N 44°00' E	491'
47-48	N 83°30' E	489'
48-49	N 44°00' E	433'
49-50	N 72°20' E	542'
50-51	N 72°00' W	380'
51-52	N 30°10' W	735'
52-53	N 07°45' W	528'
53-54	S 83°00' E	520'
54-55	N 10°00' W	609'
55-56	N 38°00' E	220'
56-57	S 39°15' E	435'
57-58	S 39°15' E	445'
58-59	N 71°30' E	765'
59-60	N 03°30' W	444'
60-61	N 88°00' W	699'
61-62	N 58°30' W	1077'
62-63	N 08°30' W	621'
63-64	N 76°30' E	605'
64-65	S 85°10' E	1030'
65-66	N 00°00' E	635'
66-67	S 65°00' E	590'
67-68	S 65°00' E	195'
68-69	S 37°00' E	1065'
69-70	S 50°00' W	723'
70-71	S 33°30' E	400'
71-72	N 37°00' E	625'
72-73	S 15°00' E	535'
73-74	S 65°00' E	210'
74-75	N 29°00' E	1210'
75-76	S 19°00' E	840'
76-77	S 70°00' E	414'
77-78	N 46°00' E	598'
78-79	S 26°30' E	900'
79-80	S 05°00' W	315'
80-81	S 65°00' E	860'
81-82	N 21°30' W	810'
82-83	N 03°30' W	1018'
83-84	N 54°45' W	531'
84-85	S 53°00' W	190'
85-86	S 84°30' W	565'
86-87	N 38°00' W	615'
87-88	S 60°30' W	515'
88-89	N 54°00' W	1120'
89-90	N 52°00' E	665'
90-91	N 76°00' W	380'
91-92	N 53°00' W	400'
92-93	N 55°00' W	232'
93-94	N 49°00' E	364'
94-95	N 49°00' E	530'
95-96	S 89°30' W	650'
96-97	S 69°30' W	320'
97-98	N 13°00' W	340'
98-99	N 13°00' W	250'
99-100	N 65°00' E	390'

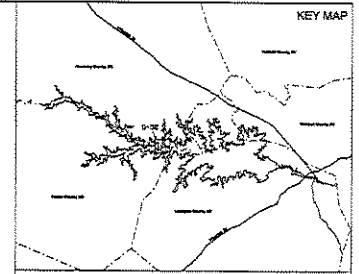
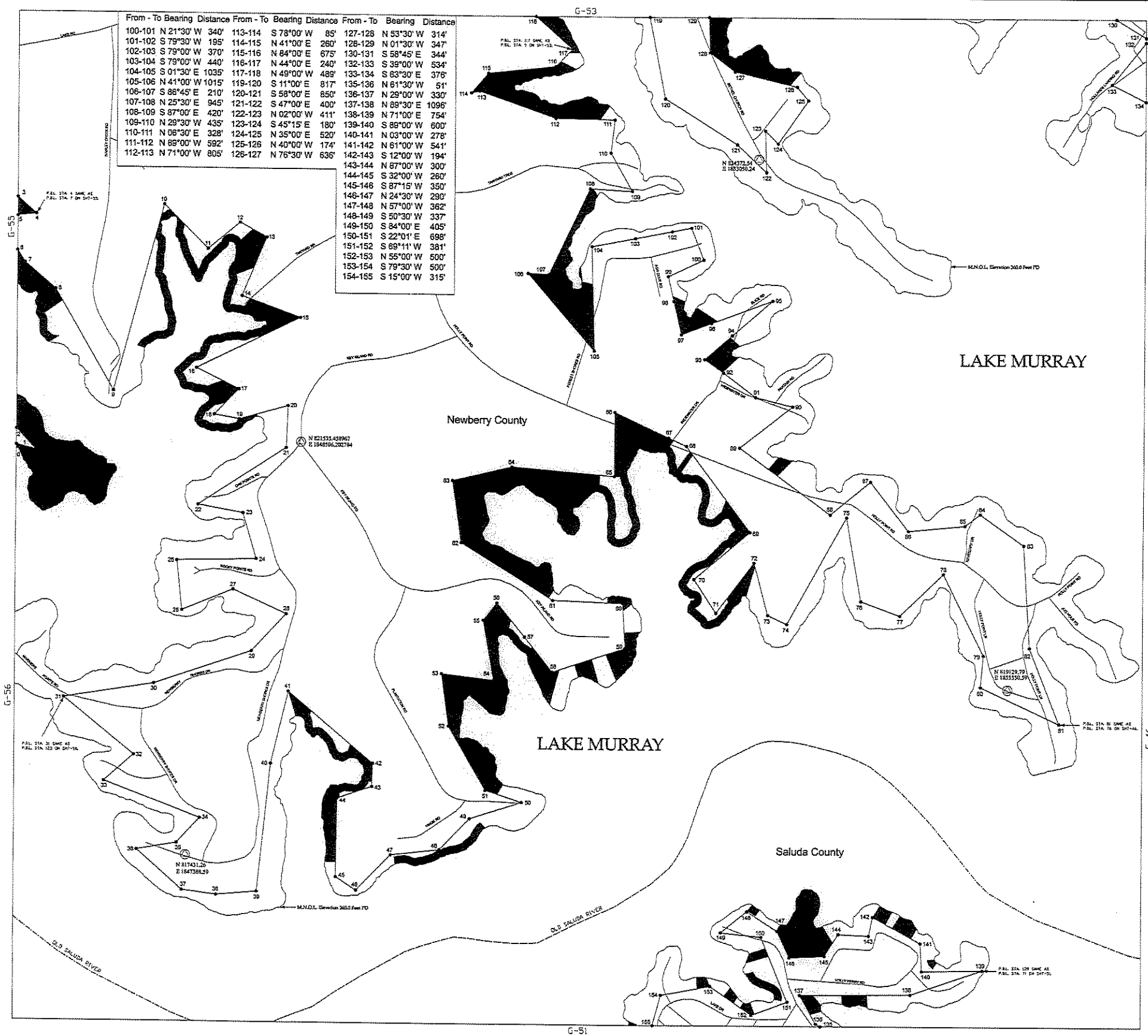

LEGEND

- Railroad
- Pipeline
- Transmission line
- Road
- Project Boundary Line
- Maximum Normal Operating Level (MNDL)
- Stream
- County Boundary
- Property owned in fee by S.C.E. & G.
- ▨ Recreation areas owned in fee by S.C.E. & G.

HORIZONTAL DATUM BASED ON THE SOUTH CAROLINA STATE PLANE COORDINATE SYSTEM (NAD83/2011) (INTERNATIONAL FOOT).

VERTICAL DATUM BASED ON NAVD83 (FEET).

TO CONVERT FROM S.C.E. & G. PLANT DATUM (PD) TO NAVD83 ADD +01.3'. THE PROJECT BOUNDARY HEIGHT IS DEFINED BASED ON S.C.E. & G. SURVEYS AND RECORDS SURVEYS AND DEEDS OF RECORD UNLESS OTHERWISE NOTED. ALL AREAS OF THE PROJECT BOUNDARY THAT ARE ELEVATION CONTROLLED WERE PROVIDED BY S.C.E. & G. AND MAPPED BY S.C.E. & G.

STEREOREDUCTION PROCESS IN ACCORDANCE WITH NATIONAL MAP ACCURACY STANDARDS. AERIAL PHOTOGRAPHY WAS PLANNED AT A SCALE APPROXIMATELY 1 INCH = 600 FEET.

I, GERARD BERNALDE, A PROFESSIONAL SOUTH CAROLINA PHOTOGRAMMETRIC SURVEYOR/MAPPER HAVE REVIEWED THE ABOVE PROJECT MAPS. THE PLANIMETRIC AND COMPOUND BOUNDS ON SAID MAPS ARE IN ACCORDANCE WITH THE NATIONAL MAP ACCURACY STANDARDS FOR THE SCALE OF 1"=100' AND WERE PRODUCED USING PHOTOGRAMMETRIC METHODS UNDER MY DIRECT SUPERVISION. ALL WORK IS BASED ON NAD83/2011 SOUTH CAROLINA STATE PLANE COORDINATE SYSTEM (INTERNATIONAL FOOT) AND THE VERTICAL DATUM IS NAVD83 (FEET).

THIS DOCUMENT WAS ORIGINALLY ISSUED AND SEALED BY GERARD BERNALDE, L-24935, ON JULY 2, 2009. THIS MAP SHALL NOT BE CONSIDERED A CORRECTED DOCUMENT.

I, GARY BAYON, A PROFESSIONAL LAND SURVEYOR IN THE STATE OF SOUTH CAROLINA P.L.L.C. 13163, HAVE REVIEWED THIS PORTION OF THE LAKE MURRAY PROJECT BOUNDARY SHOW HEREIN. THE LICENSEE EITHER OWNS IN THE WHOLE OR POSSESSES PLANNED EASEMENTS OVER THE LANDS SHOWN ON THIS MAP THAT ARE WITHIN THE PROJECT BOUNDARY. THE PROJECT BOUNDARY LINES THAT ARE NOT CONTOUR LINES WERE BASED ON S.C.E. & G. SURVEYS AND RECORDS SURVEYS AND DEEDS OF RECORD.



EXHIBIT G SHEET G-52

DETAIL MAP OF PROJECT AREA
SHEET 52 OF 77
SALUDA HYDROELECTRIC PROJECT NO. 516
SOUTH CAROLINA ELECTRIC & GAS COMPANY

SCALE: 1 INCH = 400 FEET

0 400 800 1,600
FEET

DATE: AUGUST 2009