

Project Boundary Line Traverse

From - To	Bearing	Distance
0-1	S 17°30' W	196'
1-2	N 31°45' E	220'
2-3	S 41°30' W	638'
3-4	S 70°00' E	174'
4-5	S 13°13' W	525'
5-6	N 58°15' W	500'
6-7	S 27°00' W	231'
7-8	S 76°00' W	245'
8-9	S 76°00' W	200'
9-10	S 50°15' E	140'
10-11	S 50°15' E	630'
11-12	S 86°00' W	600'
12-13	S 45°30' E	903'
13-14	S 75°30' W	465'
14-15	N 79°30' W	140'
15-16	S 08°00' E	141'
16-17	S 48°45' W	514'
17-18	S 77°00' E	777'
18-19	S 24°30' E	265'
19-20	S 69°30' E	300'
20-21	S 54°30' E	230'
21-22	S 37°00' E	490'
22-23	N 05°30' E	680'
23-24	N 20°00' E	280'
24-25	N 20°30' E	442'
25-26	S 59°45' E	501'
26-27	S 04°00' E	927'
27-28	S 89°30' E	220'
28-29	N 12°30' E	368'
29-30	N 61°00' E	115'
30-31	N 55°00' E	60'
31-32	N 22°00' W	820'
32-33	S 85°30' E	416'
33-34	S 42°15' E	452'
34-35	N 33°10' E	322'
35-36	N 07°30' W	470'
36-37	N 68°10' W	395'
37-38	N 69°00' E	365'
38-39	N 27°00' E	320'
39-40	N 11°00' E	158'
40-41	N 22°00' E	295'
41-42	S 58°45' E	1050'
42-43	S 20°30' W	625'
43-44	S 01°30' W	735'
44-45	S 65°45' W	82'
45-46	N 27°00' W	100'
46-47	S 01°30' W	140'
47-48	S 67°00' W	325'
48-49	S 13°00' E	185'
49-50	N 65°30' E	450'
50-51	N 65°30' E	221'
51-52	N 18°30' E	492'
52-53	N 69°00' E	350'
53-54	N 67°00' E	700'
54-55	S 04°00' E	350'
55-56	N 64°00' E	341'
56-57	S 89°30' E	389'
57-58	N 60°30' E	429'
58-59	N 12°00' E	80'
59-60	N 33°45' E	360'
60-61	N 45°15' E	100'
61-62	N 45°15' E	590'
62-63	S 09°45' W	580'
63-64	S 09°15' E	435'
64-65	S 06°00' E	270'
65-66	S 88°00' W	235'
66-67	S 46°39' W	278'
67-68	S 60°30' W	1119'
68-69	S 28°30' E	253'
69-70	N 74°00' W	475'
70-71	S 08°00' W	260'
71-72	N 53°30' W	420'
72-73	S 33°30' W	329'
73-74	S 63°30' W	423'
74-75	S 63°30' W	360'
75-76	S 41°10' E	410'
76-77	S 36°30' W	130'
77-78	N 70°25' W	770'
78-79	S 12°30' E	203'
79-80	N 77°00' W	455'
80-81	S 43°40' W	520'
81-82	S 53°15' W	405'
82-83	N 81°15' E	770'
83-84	S 61°00' E	218'
84-85	S 45°50' W	625'
85-86	N 71°00' W	133'
86-87	S 03°30' W	292'
87-88	N 74°50' W	500'
88-89	S 22°30' W	270'
89-90	N 39°15' W	318'
90-91	S 03°30' E	479'
91-92	S 20°00' E	218'
92-93	S 82°00' W	140'
93-94	N 42°40' W	701'
94-95	S 34°00' W	358'
95-96	N 87°00' W	250'
96-97	S 25°20' E	470'
97-98	S 67°00' W	170'

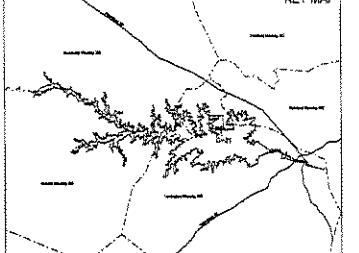
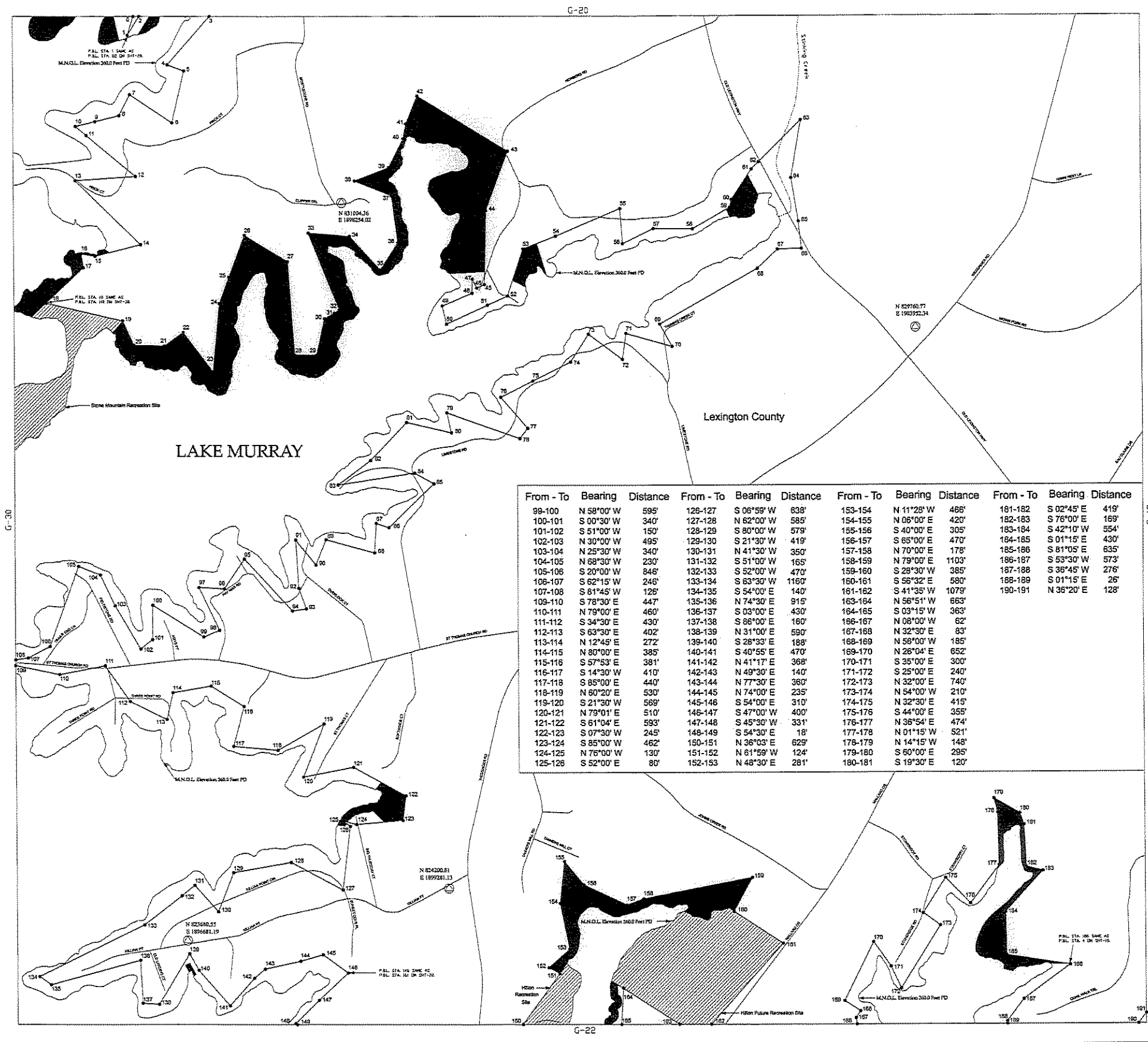

LEGEND

- Railroad
- Pipeline
- Transmission line
- Road
- Project Boundary Line
- Maximum Normal Operating Level (MNOL)
- Stream
- County Boundary
- Property owned in Fee by SCE & G
- Recreation areas owned in Fee by SCE & G

HORIZONTAL DATUM BASED ON THE SOUTH CAROLINA STATE PLANE COORDINATE SYSTEM (NAD83) (INTERNATIONAL FOOT).
 VERTICAL DATUM BASED ON NAVD83 (FEET).
 TO CORRECT FROM S.C.E. & G. PLANT DATUM (PD) TO NAVD83 IS 200 - 0.15'. THE PROJECT BOUNDARY HAS BEEN REDEFINED BASED ON S.C.E. & G. SURVEYS AND RECORDED SURVEYS AND DEEDS OF RECORD UNLESS OTHERWISE NOTED. ALL AREAS OF THE PROJECT BOUNDARY THAT ARE ELEVATION CONTIGUOUS WERE PROVIDED BY S.C.E. & G. AND MAPS BY CH2M HILL.

From - To	Bearing	Distance	From - To	Bearing	Distance	From - To	Bearing	Distance	From - To	Bearing	Distance
99-100	N 58°00' W	595'	126-127	S 06°59' W	638'	153-154	N 11°28' W	466'	181-182	S 02°45' E	419'
100-101	S 00°30' W	340'	127-128	N 62°00' W	585'	154-155	N 06°00' E	420'	182-183	S 76°00' E	169'
101-102	S 51°00' W	150'	128-129	S 80°00' W	579'	155-156	S 40°00' E	305'	183-184	S 42°10' W	554'
102-103	N 30°00' W	495'	129-130	S 21°30' W	419'	156-157	S 65°00' E	470'	184-185	S 01°15' E	430'
103-104	N 25°30' W	340'	130-131	N 41°30' W	350'	157-158	N 70°00' E	178'	185-186	S 81°05' E	635'
104-105	N 68°30' W	230'	131-132	S 51°00' W	165'	158-159	N 79°00' E	1103'	186-187	S 53°30' W	573'
105-106	S 20°00' W	846'	132-133	S 52°00' W	470'	159-160	S 28°30' W	385'	187-188	S 36°45' W	276'
106-107	S 62°15' W	246'	133-134	S 63°30' W	1160'	160-161	S 58°32' E	590'	188-189	S 01°15' E	26'
107-108	S 81°45' W	128'	134-135	S 54°00' E	140'	161-162	S 41°35' W	1079'	190-191	N 35°20' E	128'
108-109	S 78°30' E	447'	135-136	N 74°30' E	915'	162-163	N 56°51' W	663'			
109-110	N 78°00' E	460'	136-137	S 03°00' E	430'	163-164	S 03°15' W	363'			
110-111	N 34°30' E	430'	137-138	S 86°00' E	160'	164-165	S 86°00' E	62'			
111-112	S 63°30' E	402'	138-139	N 31°00' E	590'	165-166	N 32°30' E	83'			
112-113	N 12°45' E	272'	139-140	S 28°33' E	188'	166-167	N 58°00' W	185'			
113-114	N 80°00' E	385'	140-141	S 40°55' E	470'	167-168	N 26°04' E	652'			
114-115	S 57°53' E	381'	141-142	N 41°17' E	368'	168-169	S 35°00' E	300'			
115-116	S 14°30' W	410'	142-143	N 49°30' E	140'	169-170	S 25°00' E	240'			
116-117	S 85°00' E	440'	143-144	N 77°30' E	360'	170-171	S 35°00' E	740'			
117-118	N 80°20' E	530'	144-145	N 74°00' E	235'	171-172	N 54°00' W	210'			
118-119	S 21°30' W	569'	145-146	S 54°00' E	310'	172-173	N 32°00' E	415'			
119-120	N 79°01' E	510'	146-147	S 47°00' W	400'	173-174	S 44°00' E	355'			
120-121	S 61°04' E	593'	147-148	S 45°30' W	331'	174-175	N 36°54' E	474'			
121-122	S 07°30' W	245'	148-149	S 54°30' E	18'	175-176	N 01°15' W	521'			
122-123	S 85°00' W	462'	149-150	N 36°03' E	829'	176-177	N 14°15' W	148'			
123-124	N 76°00' W	130'	150-151	N 81°59' W	124'	177-178	S 60°00' E	295'			
124-125	S 52°00' E	80'	151-152	N 48°30' E	281'	178-179	S 19°30' E	120'			
125-126						180-181					

1. GERARD SEIBERLE, A PROFESSIONAL SOUTH CAROLINA PHOTOGRAMMETRIC SURVEYOR/MAPPER HAS REVIEWED THE LAKE MURRAY PROJECT MAPS. THE PLANIMETRIC AND VERTICAL DIMENSIONS ON THIS MAP ARE IN ACCORDANCE WITH THE NATIONAL MAP ACCURACY STANDARDS FOR THE SCALE OF 1"=100' AND WERE PRODUCED USING PHOTOGRAMMETRIC METHODS UNDER HIS DIRECT SUPERVISION AND WERE BASED ON NAD83/2011 SOUTH CAROLINA STATE PLANE COORDINATE SYSTEM (INTERNATIONAL FOOT) AND THE VERTICAL DATUM IS NAVD83 (FEET).
 THIS DOCUMENT WAS ORIGINALLY ISSUED AND SEALED BY GERARD SEIBERLE, 1-24625, ON JULY 1, 2008. THIS MEDIA SHALL NOT BE CONSIDERED A CERTIFIED DOCUMENT.

1. DARY BAYNE, A PROFESSIONAL LAND SURVEYOR IN THE STATE OF SOUTH CAROLINA P.L.S. 13143, HAS REVIEWED THIS PORTION OF THE LAKE MURRAY PROJECT BOUNDARY DEED HEREIN. THE LARGEST SECTION OF THE DEED IS BASED ON POSSESSION PLATINGS DATED 1978. THE LARGEST PORTION OF THIS MAP THAT ARE INSIDE THE PROJECT BOUNDARY. THE PROJECT BOUNDARY LINES THAT ARE NOT CONTIGUOUS WERE BASED ON S.C.E. & G. SURVEYS AND RECORDED SURVEYS AND DEEDS OF RECORD.



EXHIBIT G SHEET G-21
 DETAIL MAP OF PROJECT AREA
 SHEET 21 OF 77
 SALUDA HYDROELECTRIC PROJECT NO. 516
 SOUTH CAROLINA ELECTRIC & GAS COMPANY
 SCALE: 1 INCH = 400 FEET
 DATE: AUGUST 2008