

Project Boundary Line Traverse

From - To	Bearing	Distance
0-1	N 59°00' E	324'
1-2	N 00°00' E	319'
2-3	N 75°55' E	351'
3-4	N 77°37' E	750'
4-5	S 18°00' W	1213'
5-6	S 85°00' E	360'
6-7	N 44°00' E	350'
7-8	N 55°00' E	380'
8-9	S 60°00' E	120'
9-10	N 12°31' E	102'
10-11	N 58°00' E	230'
11-12	S 13°30' E	400'
12-13	N 08°00' E	590'
13-14	N 27°00' E	290'
14-15	S 53°30' E	1430'
15-16	S 21°45' E	150'
16-17	N 10°45' W	340'
17-18	N 75°30' E	40'
18-19	N 11°20' W	865'
19-20	S 77°30' E	559'
20-21	N 05°00' E	381'
22-23	S 65°15' E	900'
23-24	N 47°30' E	310'
25-26	S 18°30' E	240'
26-27	S 31°00' W	570'
27-28	S 32°30' W	370'
28-29	S 81°45' E	670'
29-30	N 45°15' E	600'
30-31	S 59°00' E	555'
31-32	S 20°15' E	415'
32-33	N 87°00' E	368'
33-34	N 31°29' W	515'
34-35	N 47°32' E	709'
35-36	N 64°30' W	385'
36-37	S 42°30' W	220'
37-38	N 84°00' W	280'
38-39	S 74°00' W	150'
39-40	N 24°00' E	415'
40-41	N 54°00' E	119'

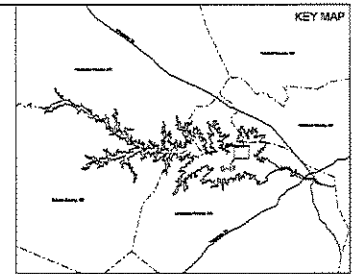
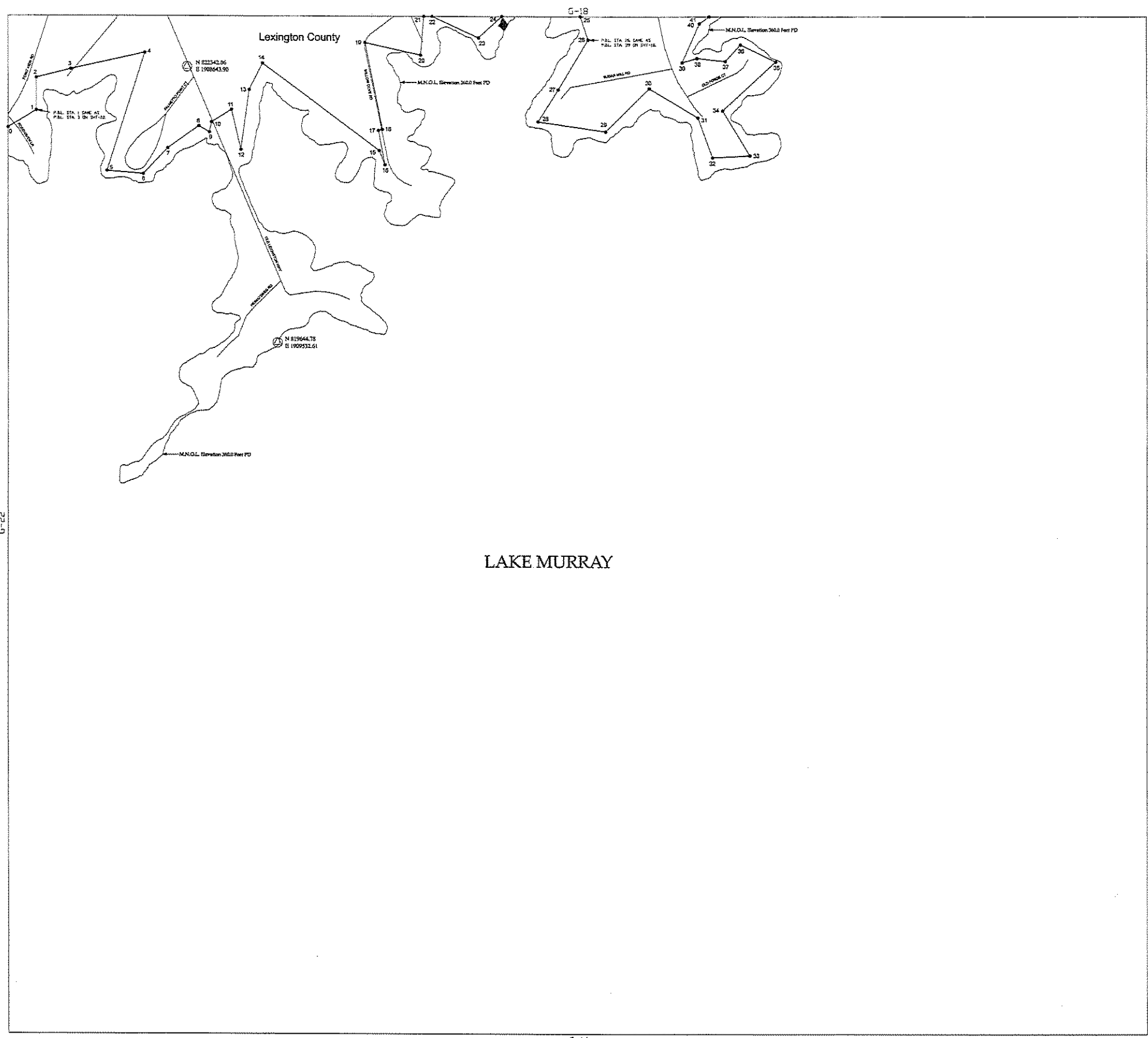

LEGEND

- Railroad
- Pipeline
- Transmission line
- Road
- Project Boundary Line
- Maximum Normal Operating Level (MNOL)
- Stream
- County Boundary
- Property owned in fee by S.C.E. & G.
- ▨ Recreation areas owned in fee by S.C.E. & G.

HORIZONTAL DATUM BASED ON THE SOUTH CAROLINA STATE PLANE COORDINATE SYSTEM NAD83/2011 (INTERNATIONAL FOOT).

VERTICAL DATUM BASED ON NAVD83 (FEET).

TO CONVERT FROM S.C.E. & G. PLANT DATA (PS) TO NAVD83 AND -01.0', THE PROJECT BOUNDARY HEREIN IS DEFINED BASED ON S.C.E. & G. SURVEYS AND RECORDED SURVEYS AND DEEDS OF RECORD UNLESS OTHERWISE NOTED. ALL AREAS OF THE PROJECT BOUNDARY THAT ARE ELEVATION CONTROLLED WERE PROVIDED BY S.C.E. & G. AND MAPPED BY GRISB, INC.

STEREOCOMPILATION PROCESS IN ACCORDANCE WITH NATIONAL MAP ACTING STANDARDS. AERIAL PHOTOGRAPHY WAS FLOWN AT A SCALE APPROXIMATELY 1:10000.

I, GERRARD SEIBERGER, A PROFESSIONAL SOUTH CAROLINA PHOTOGRAMMETRIC SURVEYOR/PILOT HAVE REVIEWED THE LARGE SCALE PROJECT MAPS. THE PLANIMETRIC AND CONTOUR DATA SHOWN ON SAID MAPS ARE IN ACCORDANCE WITH THE NATIONAL MAP ACTING STANDARDS FOR THE SCALE OF 1"=1000' AND WERE PRODUCED USING PHOTOGRAMMETRIC METHODS UNDER MY DIRECT SUPERVISION. ALL WORK IS BASED ON NAD83/2011 SOUTH CAROLINA STATE PLANE COORDINATE SYSTEM (INTERNATIONAL FOOT) AND THE VERTICAL DATUM IS NAVD83 (FEET).

THIS DOCUMENT WAS ORIGINALLY ISSUED AND SEALED BY GERRARD SEIBERGER, S-24055, ON JULY 2, 2009. THIS MEDIA SHALL NOT BE CONSIDERED A CERTIFIED DOCUMENT.

I, GARY SATON, A PROFESSIONAL LAND SURVEYOR IN THE STATE OF SOUTH CAROLINA P.L.S. 12161, HAVE SUPERVISED THIS PORTION OF THE LARGE SCALE PROJECT BOUNDARY SHOWN HEREIN. THE MEASUREMENTS EITHER MADE IN THE FIELD OR IN THE LABORATORY FOR THE LAND SURVEY ON THIS MAP THAT ARE INSIDE THE PROJECT BOUNDARY. THE PROJECT BOUNDARY LINES THAT ARE NOT CONTOUR LINES WERE BASED ON S.C.E. & G. SURVEYS AND RECORDED SURVEYS AND DEEDS OF RECORD.



EXHIBIT G SHEET G-17

DETAIL MAP OF PROJECT AREA
SHEET 17 OF 77
SALUDA HYDROELECTRIC PROJECT NO. 516
SOUTH CAROLINA ELECTRIC & GAS COMPANY

SCALE: 1 INCH = 400 FEET

0 400 800 1,600
FEET

DATE: AUGUST 2008