

Project Boundary Line Traverse		
From - To	Bearing	Distance
0-1	N 80°33' W	88'
1-2	S 11°27' W	1192'
2-3	N 75°31' W	148'
3-4	N 63°30' W	215'
4-5	S 83°52' W	390'
5-6	N 32°08' W	330'
6-7	N 72°52' E	530'
7-8	N 32°52' E	70'
8-9	N 11°18' W	280'
9-10	N 29°12' E	150'
10-11	N 73°12' E	290'
11-12	N 32°52' E	250'
12-13	N 37°20' W	380'
13-14	N 26°45' E	588'
14-15	N 78°18' W	471'
15-16	S 35°12' W	752'
16-17	S 79°02' W	305'
17-18	N 56°43' W	140'
18-19	S 85°17' W	280'
19-20	S 30°20' W	273'
20-21	N 73°25' W	115'
21-22	N 39°26' E	195'
22-23	N 13°05' W	205'
23-24	N 28°55' W	195'
24-25	N 89°25' W	335'
25-26	S 46°40' W	1002'
26-27	N 40°20' W	140'
27-28	N 38°10' E	272'
28-29	N 03°40' W	245'
29-30	N 16°55' W	592'
30-31	S 76°50' E	344'
31-32	N 50°0' E	637'
32-33	N 41°50' E	769'
33-34	S 89°57' E	100'
34-35	N 25°34' E	165'
35-36	N 81°25' W	92'
36-37	S 88°20' W	627'
37-38	N 57°38' W	765'
38-39	S 74°30' W	145'
39-40	N 25°58' E	110'
40-41	N 57°00' E	900'
41-42	N 04°01' W	480'
42-43	S 77°59' W	428'
43-44	N 30°01' W	741'
44-45	S 19°52' W	120'
45-46	S 84°58' W	340'
46-47	S 13°11' E	314'
47-48	S 38°33' W	284'
48-49	N 54°29' W	287'
49-50	S 23°27' W	207'
50-51	S 22°38' E	497'
51-52	S 50°19' W	325'
52-53	N 38°28' W	544'
53-54	S 16°46' W	99'
54-55	S 66°44' W	297'
55-56	N 67°58' W	369'
56-57	N 67°58' W	70'
57-58	N 67°58' W	167'
58-59	N 05°50' E	138'
59-60	N 68°20' W	140'
60-61	N 81°12' W	194'
61-62	N 02°05' W	312'
62-63	N 08°00' E	110'
63-64	N 43°00' W	165'
64-65	N 32°00' W	550'
65-66	N 08°00' E	310'
66-67	N 59°45' E	338'
67-68	S 12°00' E	580'
68-69	S 28°00' E	775'
69-70	N 63°30' E	660'
70-71	N 01°00' W	240'
71-72	N 51°00' E	310'
72-73	S 42°30' E	280'
73-74	N 57°00' E	360'
74-75	N 07°00' E	310'
75-76	S 57°30' E	680'
76-77	N 62°30' E	160'
77-78	N 08°00' E	1100'
78-79	S 44°30' E	250'
79-80	S 44°37' E	1259'
80-81	N 00°30' E	641'
81-82	N 76°30' E	245'
82-83	N 66°00' E	1015'
83-84	N 40°00' E	387'
84-85	N 71°30' W	1362'
85-86	N 85°30' W	224'
86-87	N 08°00' W	650'
87-88	N 42°30' W	530'
88-89	N 82°00' W	491'
89-90	N 22°30' W	195'
90-91	N 81°45' E	850'
91-92	S 25°00' E	413'
92-93	N 40°00' E	535'
93-94	N 81°45' E	231'
94-95	S 08°00' E	470'
95-96	S 24°00' E	760'
96-97	S 45°00' E	780'
97-98	N 08°40' E	750'

From - To	Bearing	Distance
98-99	S 58°00' E	272'
100-101	N 58°10' W	441'
101-102	N 11°00' E	150'
102-103	N 06°30' W	250'
103-104	N 54°30' W	100'
104-105	N 48°00' E	210'
105-106	S 69°00' E	321'
107-108	N 55°00' W	32'
108-109	N 40°00' E	40'
110-111	N 24°19' W	28'
111-112	S 88°30' W	628'
112-113	N 70°00' E	107'

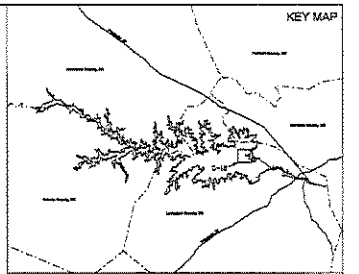
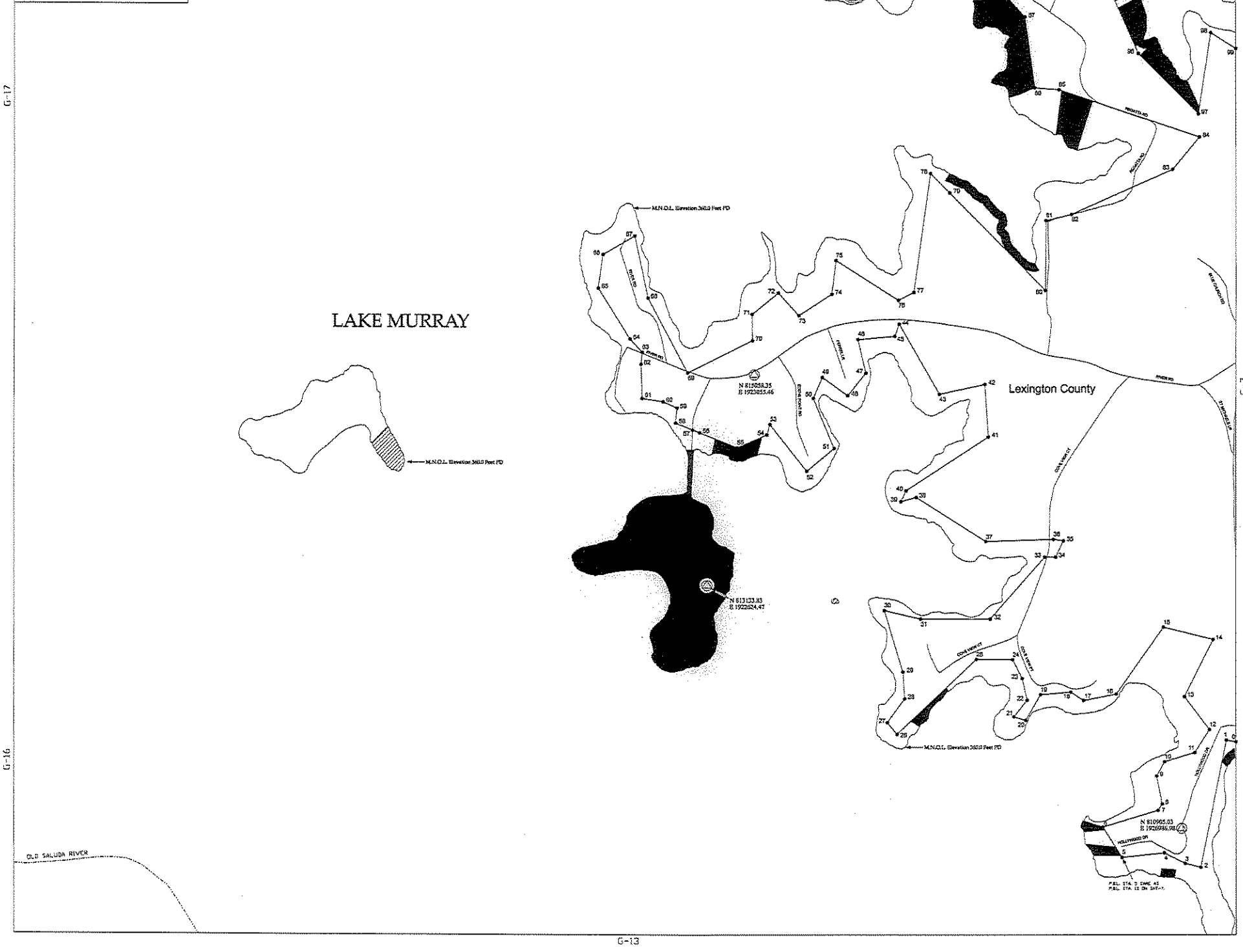

**LEGEND**

- Railroad
- Pipeline
- Transition line
- Road
- Project Boundary Line
- Maximum Normal Operating Level (M.N.O.L.)
- Stream
- County boundary
- Property owned in Fee by S.C.E. & G.
- ▨ Recreation areas owned in Fee by S.C.E. & G.

HORIZONTAL DATUM BASED ON THE SOUTH CAROLINA STATE PLANE COORDINATE SYSTEM MAPS/2001 (INTERNATIONAL FOOT).  
 VERTICAL DATUM BASED ON NAVORS (FEET).  
 TO CONVERT FROM S.C.E. & G. PLANE DATUM (PD) TO NAVORS ADD +01.57'. THIS PROJECT BOUNDARY HEIGHT IS DEFINED BASED ON S.C.E. & G. SURVEYS AND RECORDS SURVEYS AND RECORDS OF RECORD UNLESS OTHERWISE NOTED. ALL AREAS OF THE PROJECT BOUNDARY THAT ARE ELEVATION CONTROL WERE PROVIDED BY S.C.E. & G. AND MAPPED BY ORSIS, INC.

STEREOREPRODUCTION PROCESS IN ACCORDANCE WITH NATIONAL MAP ACCURACY STANDARDS. AERIAL PHOTOGRAPHS WERE FLOWN AT A SCALE APPROXIMATELY 1:50,000.

I, GERHARD DENHARZ, A PROFESSIONAL SOUTH CAROLINA PHOTOGRAMMETRIC SURVEYOR/HAPSER HAVE REVIEWED THE LAKE MURRAY PROJECT MAPS. THE PLANIMETRIC AND COMPOUND SHOWN ON THIS MAP ARE IN ACCORDANCE WITH THE NATIONAL MAP ACCURACY STANDARDS FOR THE SCALE OF 1"=100' AND WERE PRODUCED USING PHOTOGRAMMETRIC METHODS UNDER MY DIRECT SUPERVISION. ALL WORK IS BASED ON MAPS/2001 SOUTH CAROLINA STATE PLANE COORDINATE SYSTEM (INTERNATIONAL FOOT) AND THE VERTICAL DATUM IS NAVORS (FEET).

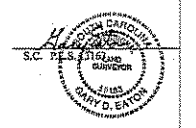

EXHIBIT G SHEET G-12  
 DETAIL MAP OF PROJECT AREA  
 SHEET 12 OF 77  
 SALUDA HYDROELECTRIC PROJECT NO. 516  
 SOUTH CAROLINA ELECTRIC & GAS COMPANY  
 SCALE: 1 INCH = 400 FEET  
 DATE: AUGUST 2008